

PLEASE READ THE INSTRUCTIONS CAREFULLY BEFORE FITTING THE KIT

Follow the sequence 1 to 9.3, together with the drawings.

If you have a problem, however small, call our Technical Department.

Tel:- 01925 636950. Fax:- 01925 243111. Mon - Thurs 8.30 - 5pm.

- 1 Remove the plastic air duct from the front panel and from the air intake pipe. **Drawing A.**
- 2 Release the front grille **Drawing A.**
- 3 Press spring clip to remove the plug from the sensor. **Drawing B.** Unscrew the sensor and remove . Release **Hose A.**
- 4 Remove the breather hose, **Drawing B** and release the small **Hose B.**
- 5 Using the side cutters, or stanley knife (take care), remove the plastic tie attached to the intake to the airbox, pull out the cable, **Drawing C,** Remove the intake pipe from the air filter box and from the flexi air intake pipe.
- 6 Release the large hose clip, **Drawing B,** and lift out the complete air box assembly .
- 7 First screw the sensor into the shortened inlet on the tapered adapter, **see Drawing D** for fitting instructions. **Read carefully, before fitting this filter. Push hose A and hose B,** just inside the holes in the base of the air filter. **Drawing F,** fit the filter to the metal tube. Tighten the clip, until it just rotates, then one full turn (360 degree's). **No more. Do not overtighten.**
- 8 **SAFETY NOTE, DRAWING E. FOLLOW THE INSTRUCTIONS CAREFULLY.**
- 9 **Fitting the essential cold air system Drawing D & G.**
- 9.1 **See Drawings H1. H2 & H3** for attaching cold air hose to duct.
- 9.2 Feed the rubber hose down behind the grille, position hose to achieve the best intake flow **Drawing G.** Refit the plastic air duct to the front panel. **Drawing D.**
- 9.3 Fit the tapered end of straight cold air hose into the flexi pipe. Secure with two long plastic ties, as **Drawing D.**
10. **Tuning.**
CAT. Cars. No adjustments are required.
An increase in fuel may be required if further engine modifications are carried out.
- 11 **Filter maintenance.**
Under normal conditions clean and reoil the filter at approx. 40,000 miles / 65,000 Km.
Use only K&N cleaner and oil with this kit and reoil and follow the instructions carefully.

K&N Filters are pre oiled ready to fit.

The advantage's of K&N's cold air system.

Cooler air being denser, will show positive improvements in power filter systems that draw hot air from the engine bay.

This Kit Should Contain :-

- 1 x Air filter.
- 1 x Nylon Adaptor
- 1 x Rubber breather hose.
- 2 x Rubber cold air hoses
- 1 x Instruction sheet
- 1 x Instruction pack.
 - 1 x Filter maintenance sheet
 - 1 x K&N Window Sticker
 - 1 x Million mile warranty card
 - 1 x Leaflet
- 1 x Fixing Kit
 - 1 x Hose Clip (Size 44)
 - 1 x Hose Clip (size 40.)
 - 1 x Hose Clip (size 40 thin.)
 - 2 x Plastic Cable Tie (35cm Long).
 - 2 x Plastic Cable Tie (10cm Long)
 - 1 x Metal Tube

FITTING YOUR OWN 57i KIT

If no **it is essential** that the person fitting the kit (e.g mechanic) **carefully follows these particular instructions** even if he has fitted K&N kits before. This will save you both time and money. Kits incorrectly fitted may show a loss in performance e.g the positioning of the essential cold air hose, (flexi expandable and rubber hoses are used).

A final check under the bonnet by yourself with the instructions, would seem sensible.

Release the four screws.
Pull the grille section forward to give access for fitting the new rubber hose

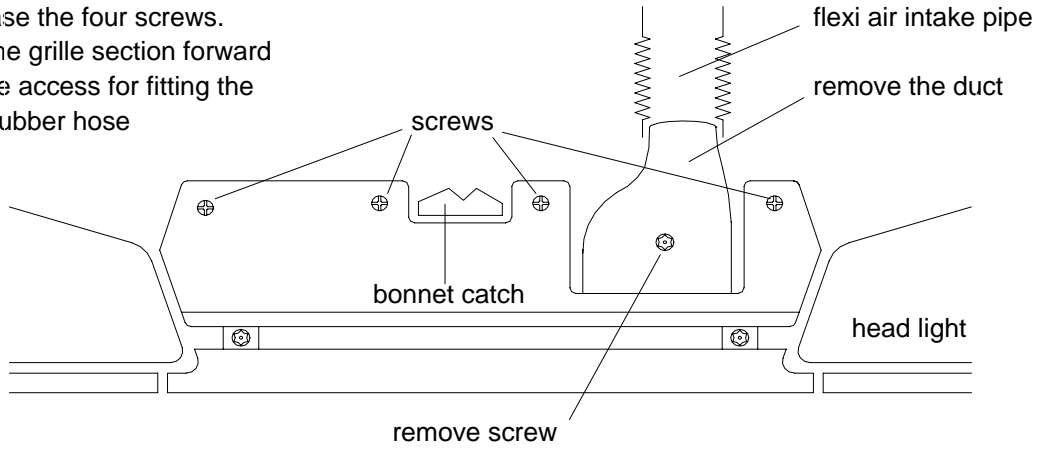

Drawing B

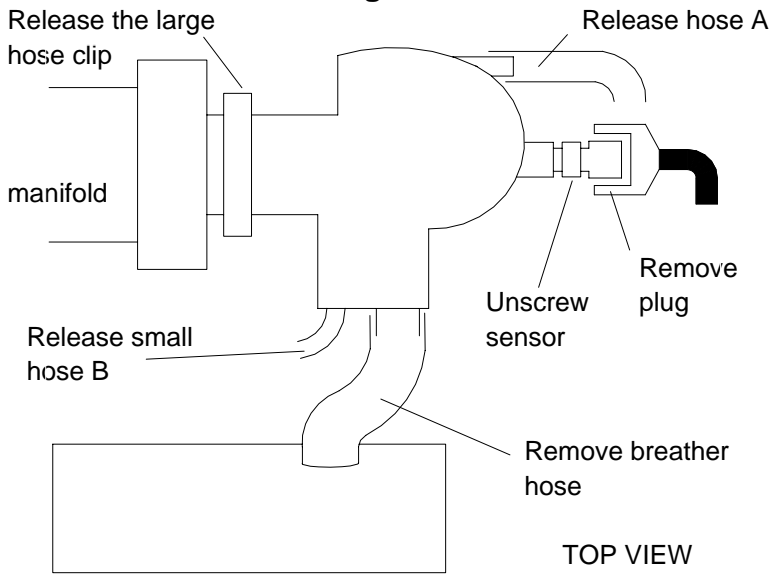

Drawing C

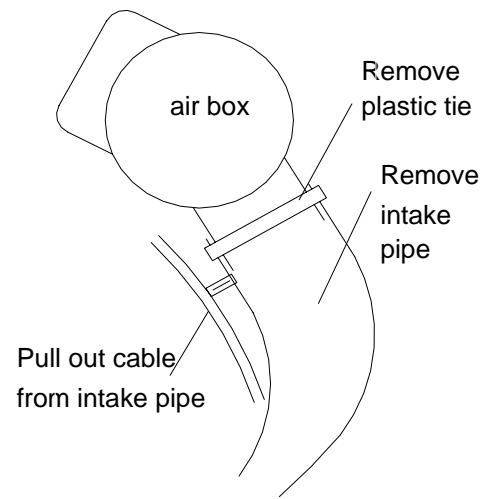

Drawing D

1- Screw sensor into short outlet first

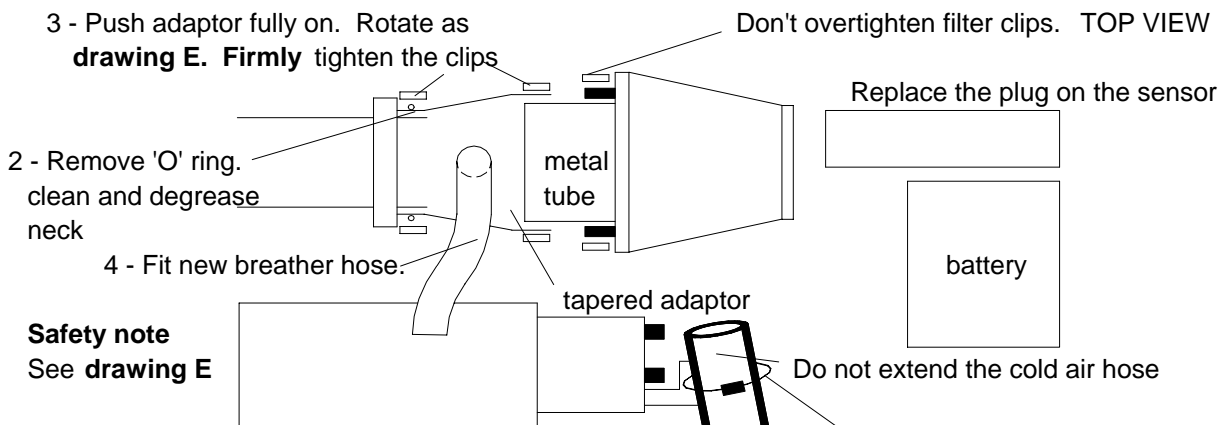

Drawing D-1

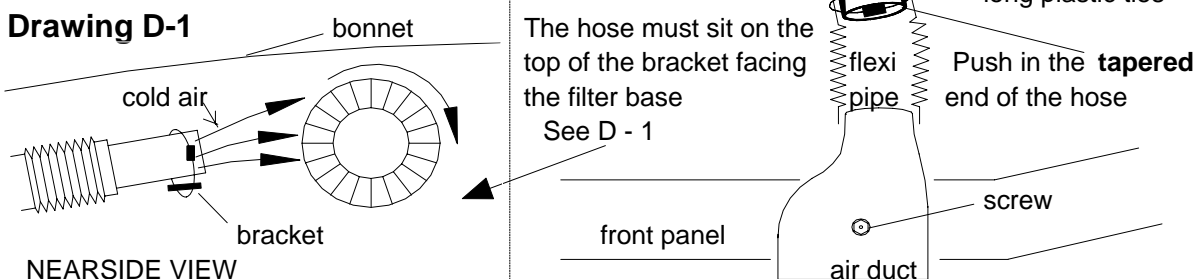

Drawing E

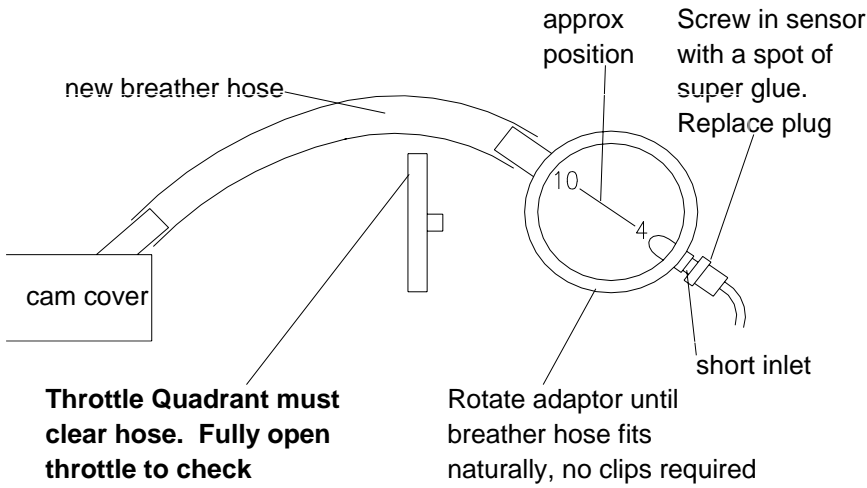

Drawing F

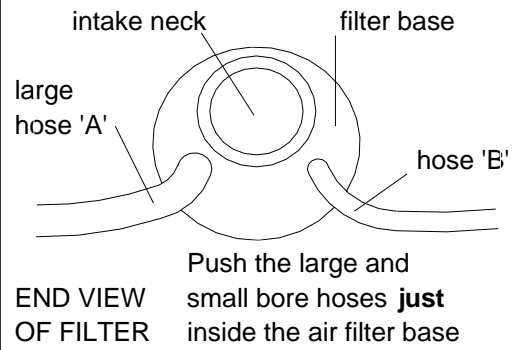

Drawing G

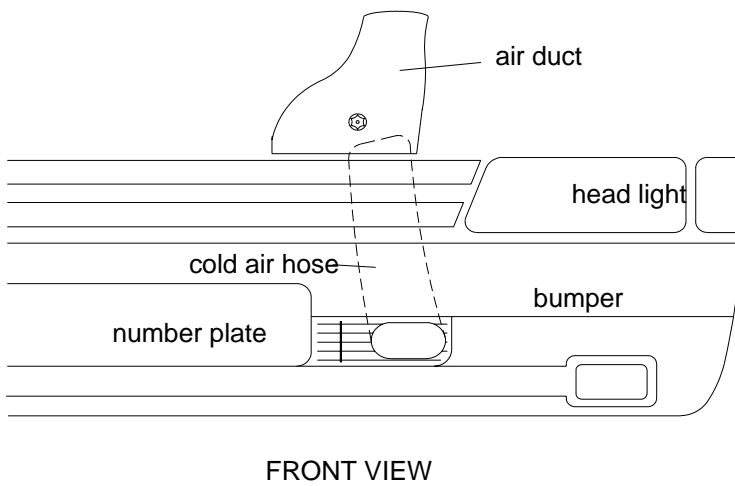

Drawing H1

TOP VIEW

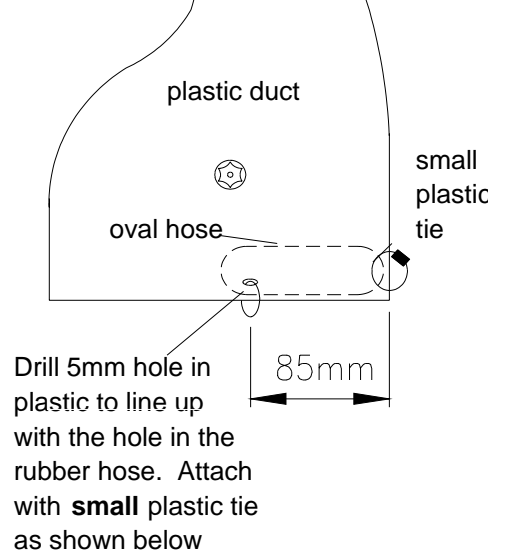

Drawing H2

SIDE VIEW

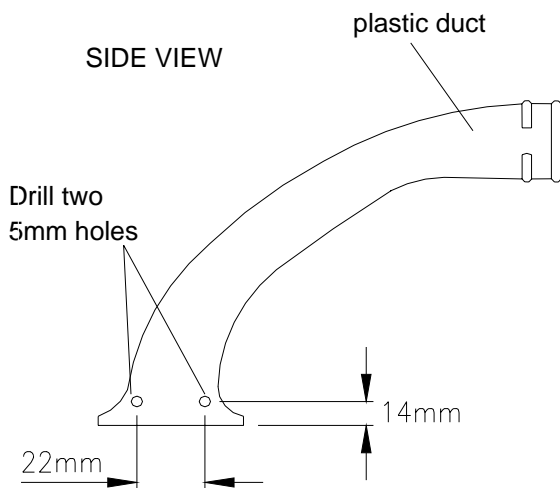

Drawing H3

