

- IMPORTANT, Read First - IMPORTANTE, Lea Primero - IMPORTANT, Read First -

IMPORTANT! - Install "Core Adapter" First 6.0L Ford Powerstroke Oil Filter Instructions

- IMPORTANT, Read First - IMPORTANTE, Lea Primero - IMPORTANT, Read First -

Service Instructions:

1. A "Core Adapter" is required to install this filter into all 6.0L Ford Powerstroke housings. With the core adapter installed, you may still use the OEM and all other brands of filters.
2. If a core adapter has already been installed, proceed to step 6, filter installation.
3. Align the slots of the core adapter with the holes on the topside of the core assembly. (See Fig. 1)
4. Carefully push adapter into the core assembly. Mild resistance may be felt during installation. (See Fig. 2)
5. With core adapter in position, (See Fig. 3), press core adapter firmly to snap in place. (See Fig. 4)
6. Remove the old O-ring, lubricate new O-ring with clean oil and install on cap.
7. Install filter element and threaded cap.
8. Tighten cap to 18.5 ft-lbs.

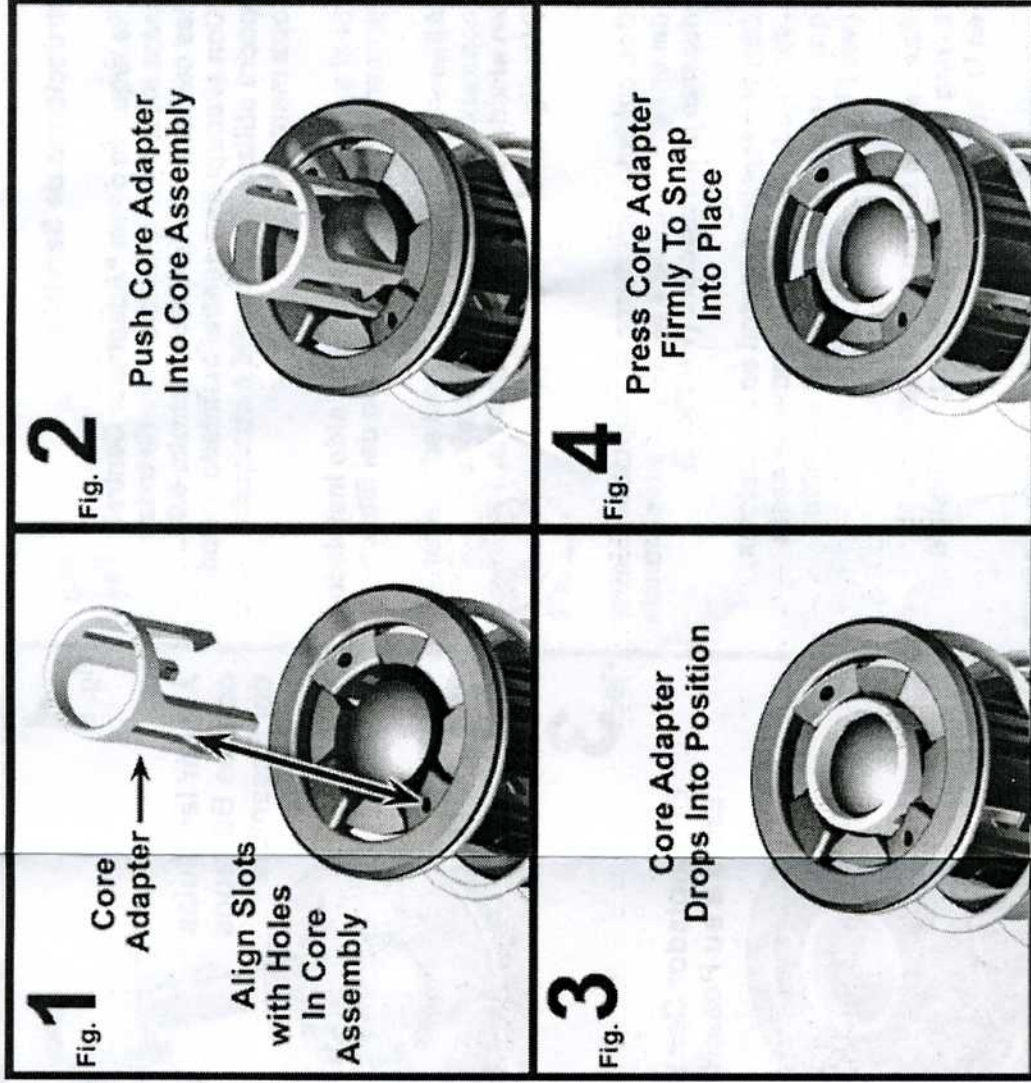

Need Help? See www.coreadapter.com for more details and installation video.

Part No. 40-34484 11-1-06

- IMPORTANT, Read First - IMPORTANTE, Lea Primero - IMPORTANT, Read First -