



# TYPHOON INTAKE SYSTEMS



## INSTALLATION INSTRUCTIONS

### 69-2004

### MINI

### 2007-10 Cooper S

### L4 - 1.6L Turbo

#### TOOLS NEEDED:

- 4mm allen wrench
- 10mm socket extension
- flat blade screwdriver
- ratchet
- T27 TORX
- T25 TORX

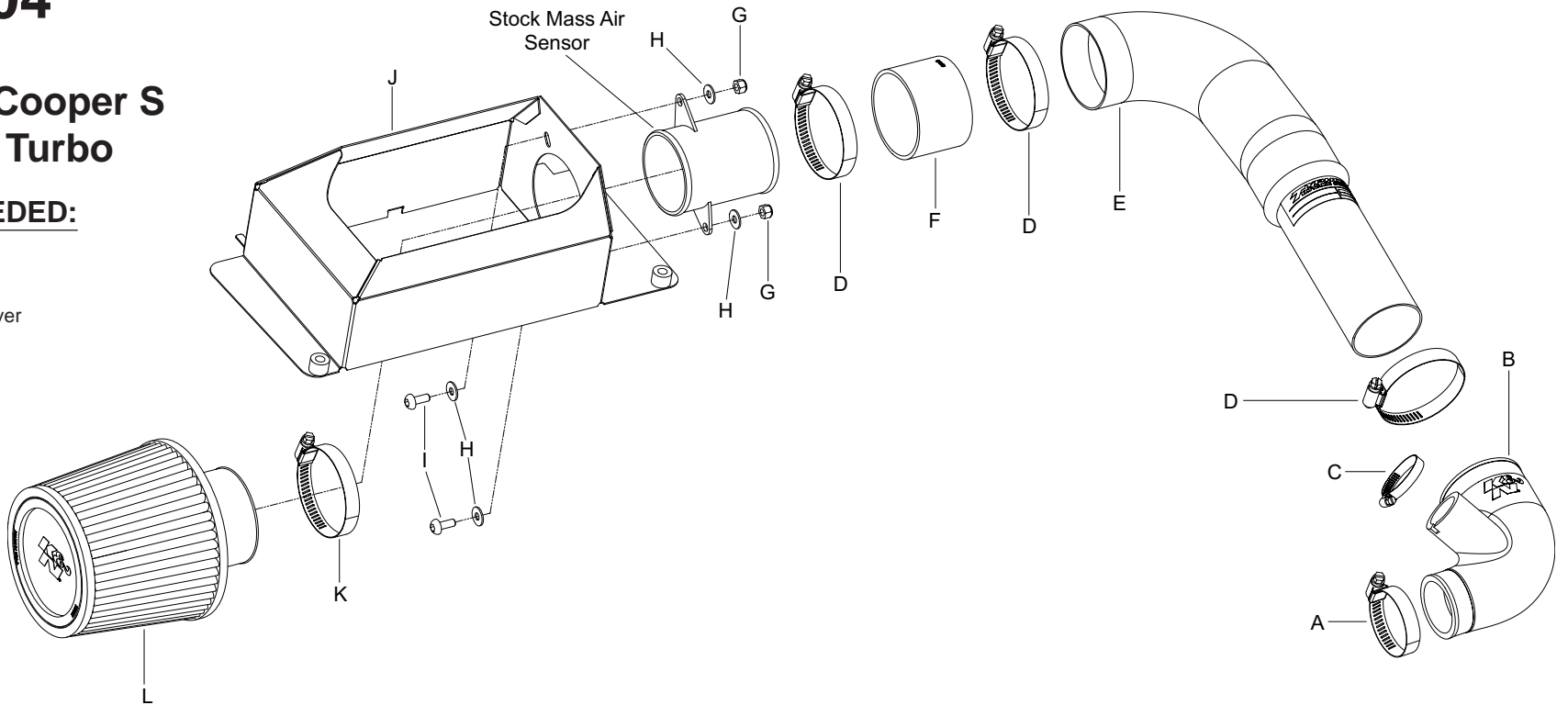

#### PARTS LIST:

Description	Qty.	Part #	Description	Qty.	Part #
A Hose Clamp #28	1	08483	G Nut; 6MM Nylcok, Hexhead, SS	2	07512
B Hose; 2-1/2" TO 1-3/4" ID 87DEG Angled 1-1/8" Vent Molded	1	08484	H Washer; 6MM Flat, SS	4	08269
C Hose Clamp #20 Mini	1	08431	I Bolt; M6 X 1.00 X 16MM , Buttonhead, SS	2	07730
D Hose Clamp #40	3	08554	J Heat Shield	1	073107
E Intake Tube	1	27431	K Hose Clamp # 44	1	08577
F Hose; 2-3/4" ID X 2" L Reinforced	1	08440	L Air Filter	1	RU-4960

**NOTE: FAILURE TO FOLLOW INSTALLATION INSTRUCTIONS AND NOT USING THE PROVIDED HARDWARE MAY DAMAGE THE INTAKE TUBE, THROTTLE BODY AND ENGINE.**

#### TO START:

1. Turn off the ignition and disconnect the negative battery cable.

**NOTE: Disconnecting the negative battery cable erases pre-programmed electronic memories. Write down all memory settings before disconnecting the negative battery cable. Some radios will require an anti-theft coded to be entered after the battery is reconnected. The anti-theft code is typically supplied with your owner's manual. In the event your vehicles' anti-theft code cannot be recovered, contact an authorized dealership to obtain your vehicles anti-theft code.**

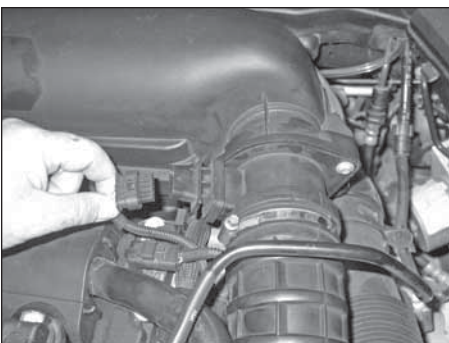

2. Disconnect the mass air sensor electrical connection.

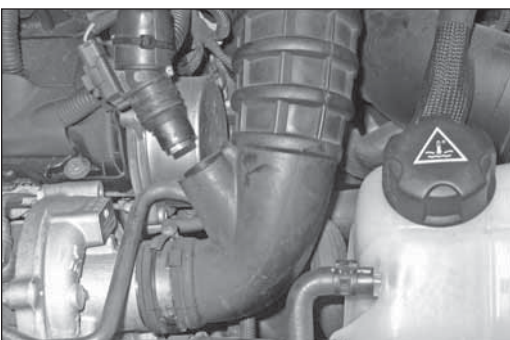

3. Disconnect the crank case vent hose from the intake tube as shown.

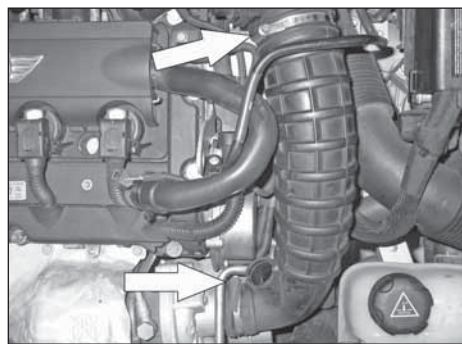

4. Loosen the two hose clamps which secure the intake tube to the turbo inlet and air box.

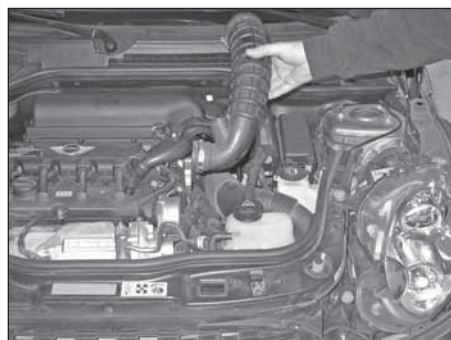

5. Remove the stock intake tube from the vehicle. **NOTE: K&N Engineering, Inc., recommends that customers do not discard factory air intake.**

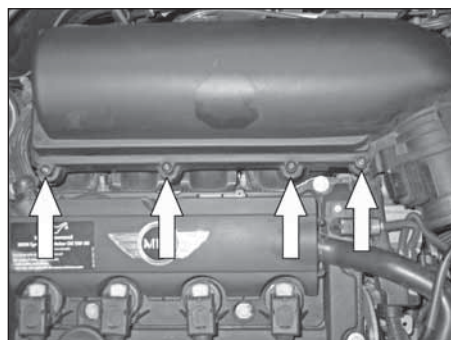

6. Loosen the four screws which secure the upper air box to the lower air box, then remove the upper air box and air filter from the vehicle.

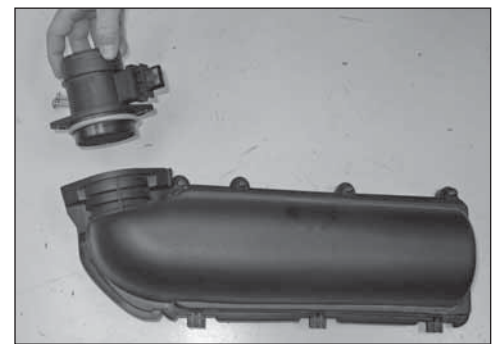

7. Remove the two screws which secure the mass air sensor to the upper air box and then remove the mass air sensor from the upper air box.

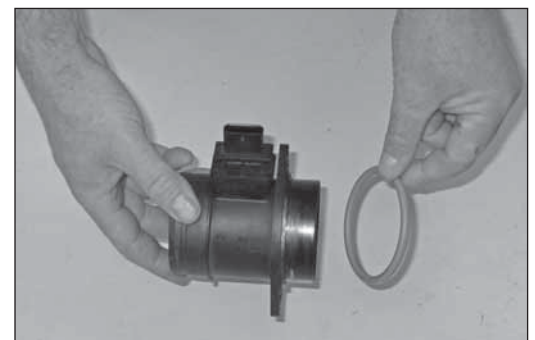

8. Remove the mass air sensor from the air box, and then remove the "O" ring gasket from the mass air sensor.

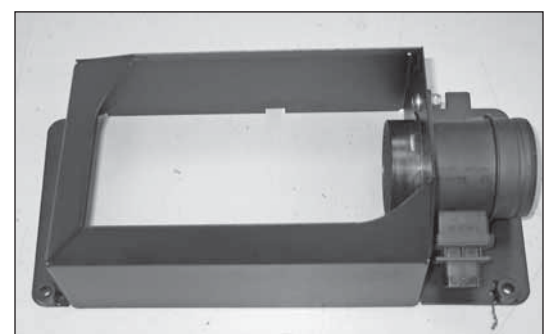

9. Install the mass air sensor into the heat shield and secure with the provided hardware. **NOTE: Be sure to install the button head bolts from the inside of the heat shield out.**

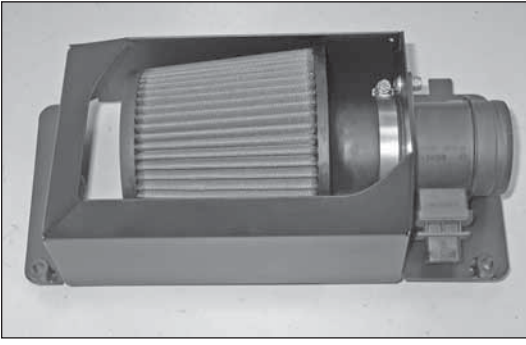

10. Install the K&N® air filter onto the mass air sensor inside the heat shield and secure with the provided hose clamp.

**NOTE: Drycharger® air filter wrap; part number RX-4990DK is available to purchase separately. To learn more about Drycharger® filter wraps or look up color availability please visit <http://www.knfilters.com>®.**

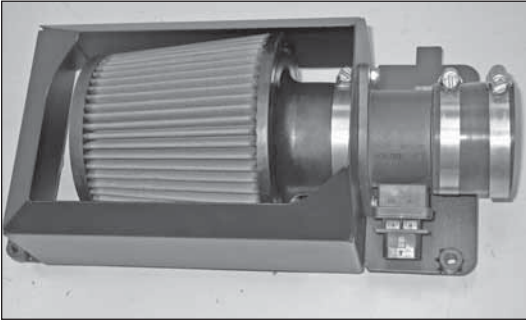

11. Install the provided silicone hose (08440) onto the mass air sensor and secure with the provided hose clamp.

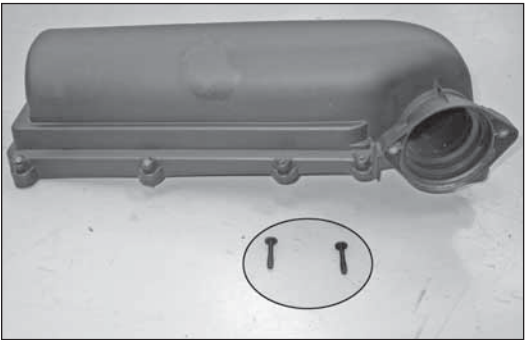

12. Remove two of the upper air box mounting screws from the upper air box.

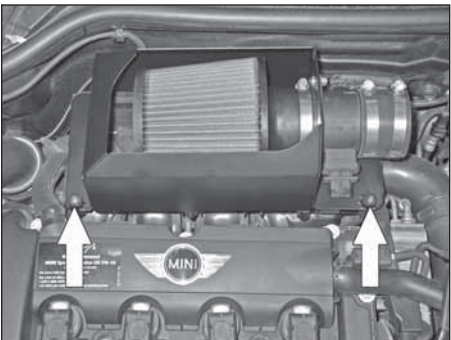

13. Install the heat shield assembly onto the lower air box. Secure the heat shield assembly to the lower air box with the two screws removed from the upper air box in step #12.

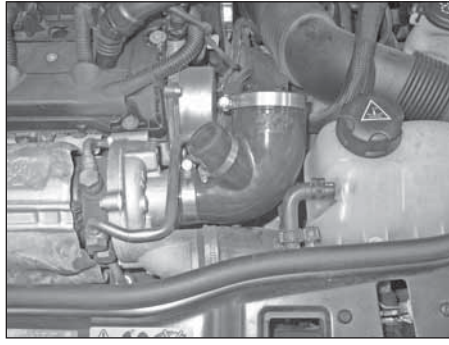

14. Install the silicone hose (08484) onto the turbo inlet and secure with the provided hose clamp.

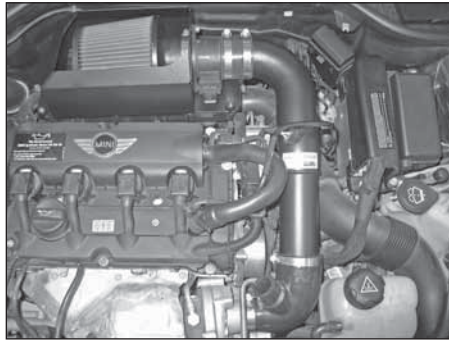

15. Install the K&N® intake tube into the silicone hoses on the turbo inlet and mass air sensor and then secure with the provided hose clamp.

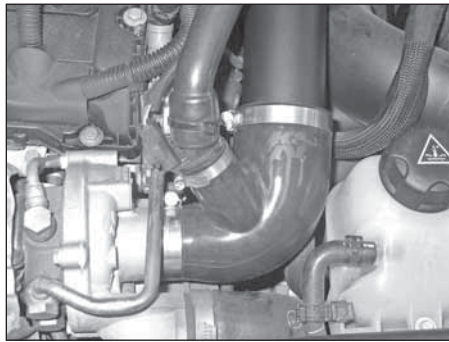

16. Install the crank case vent hose into the silicone hose at the turbo inlet and secure with the provided hose clamp.

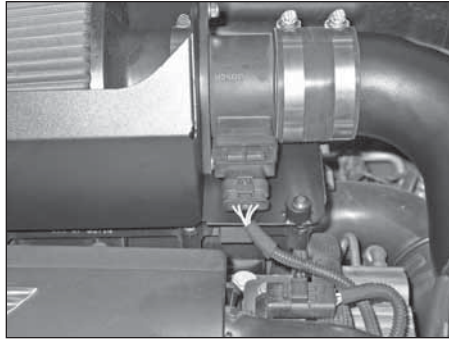

17. Reconnect the mass air sensors electrical connection.

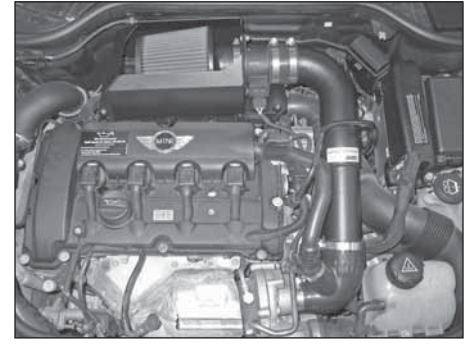

18. Reconnect the vehicle's negative battery cable. Double check to make sure everything is tight and properly positioned before starting the vehicle.

19. It will be necessary for all K&N® high flow intake systems to be checked periodically for realignment, clearance and tightening of all connections. Failure to follow the above instructions or proper maintenance may void warranty.

#### ROAD TESTING:

1. Start the engine with the transmission in neutral or park, and the parking brake engaged. Listen for air leaks or odd noises. For air leaks secure hoses and connections. For odd noises, find cause and repair before proceeding. This kit will function identically to the factory system except for being louder and much more responsive.

2. Test drive the vehicle. Listen for odd noises or rattles and fix as necessary.

3. If road test is fine, you can now enjoy the added power and performance from your kit.

4. K&N Engineering, Inc., suggests checking the air filter element periodically for excessive dirt build-up. When the element becomes covered in dirt (or once a year), service it according to the instructions on the Recharger® service kit, part number 99-5050 or 99-5000

**STREET LEGAL IN MOST STATES**

**NOT LEGAL FOR USE IN CA & OTHER STATES  
ADOPTING CA EMISSIONS STANDARDS**

**See our catalog or [knfilters.com](http://knfilters.com) for CARB status on each part for a specific vehicle**

\* FREE K&N® decal To register your warranty, please see us online at [knfilters.com/register](http://knfilters.com/register). FREE K&N® decal \*

• 1455 CITRUS ST., P.O. BOX 1329, RIVERSIDE, CA., U.S.A. 92502 • TECH SERVICE 800-858-3333 • FAX 951-826-4001  
• e-mail: [tech@knfilters.com](mailto:tech@knfilters.com) • WWW: <http://www.knfilters.com>®