



AIRCHARGER® HIGH-FLOW INTAKE KITS

INSTALLATION INSTRUCTIONS

63-1552

DODGE / JEEP

2008-10 CALIBER

2008-10 COMPASS

2007-10 PATRIOT

I4-1.8/2.0/2.4L

NOTE: This kit was not designed to fit vehicles with a body lift.

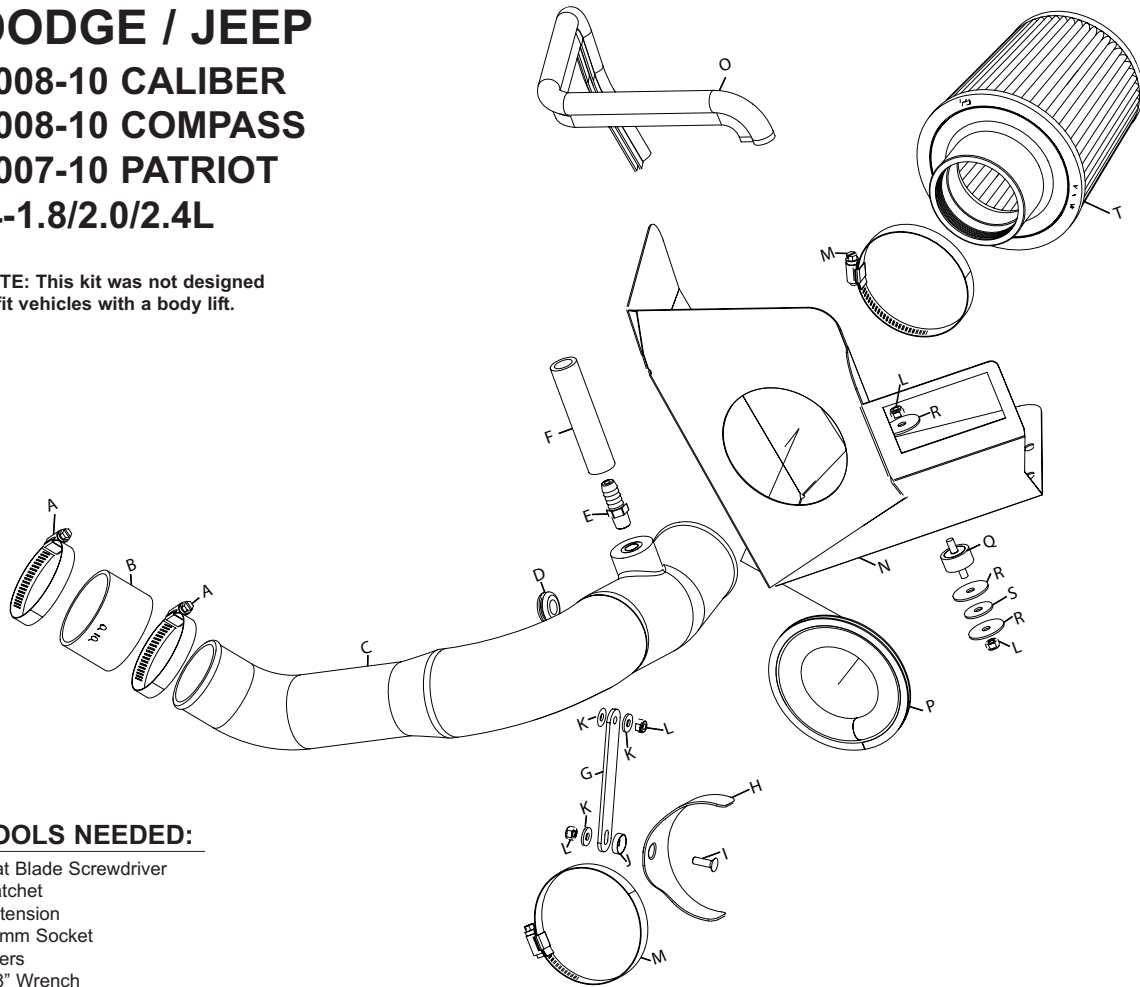

PARTS LIST:

Description	Qty	Part #
A Hose clamp #40	2	08554
B Hose; 2.63" id X 1.75" L, silicone	1	08108
C Intake tube	1	087206
D Grommet; 1-1/16 od, 1/2 id, 3/8 thk	1	080544
E Vent; str 1/2" hose, 1/4" npt, plas	1	080022
F Hose; 1/2" id X 4-1/2" L, silicone	1	08485
G Bracket; mild stl. fb/pc	1	26636
H Bracket; saddle ss	1	078855
I Bolt; 6mm-1.00 X 20mm f/h/a, ss	1	08376
J Washer; conical, nylon, black	1	08180
K Washer; 1/4" id X 5/8" od - sae	3	08275
L Nut; 6mm nylock hexhead	4	07553
M Hose Clamp #48	2	08601
N Heat shield	1	07637
O Edge trim (23")	1	102495
P Edge trim (17")	1	102469
Q Stud; m6-1.00 m/m, rubber mntd	1	07027
R Washer; 1.25d X .28 hol zn062	3	08151
S Washer; 1" X .300 X .100 rubber	1	21685
T Air filter	1	RU-4730

TOOLS NEEDED:

- Flat Blade Screwdriver
- Ratchet
- Extension
- 10mm Socket
- Pliers
- 5/8" Wrench

NOTE: FAILURE TO FOLLOW INSTALLATION INSTRUCTIONS AND NOT USING THE PROVIDED HARDWARE MAY DAMAGE THE INTAKE TUBE, THROTTLE BODY AND ENGINE.

TO START:

1. Turn the ignition OFF and disconnect the vehicle's negative battery cable.



2. Pull up firmly to dislodge the engine cover from the mounting grommets. Then remove the engine cover from the vehicle.



3. Rotate the fresh air tube fasteners counter clockwise to unlock them from the radiator core support.



4. Remove the fresh air duct from the stock air filter housing and radiator core support.



5. Depress the locking tab and disconnect the inlet air temperature sensor's electrical connection.



6. Loosen the hose clamp that secures the stock intake tube to the factory air filter housing.



7. Disconnect the crank case vent hose from valve cover.



8. Pull up firmly to dislodge the air box from the mounting grommets and then remove the air box from the vehicle.

NOTE: K&N recommends that customers do not discard factory air intake.



9. Loosen the hose clamp at the lower end of the stock intake tube from the vehicle.

NOTE: Be sure the engine is cool before attempting to loosen the intake tube hose clamp to prevent being burnt by hot components.



10. Remove the stock intake tube from the vehicle.

NOTE: Be sure to unclip the wiring harness from the intake tube as you remove the tube from the vehicle.



11. Remove the air box mounting grommet shown.

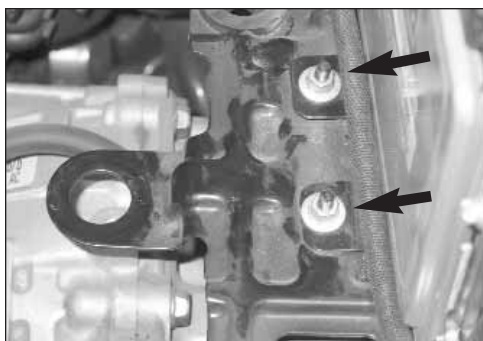

12. Remove the two air box mounting nuts shown.
NOTE: These nuts will be reused in a later step.

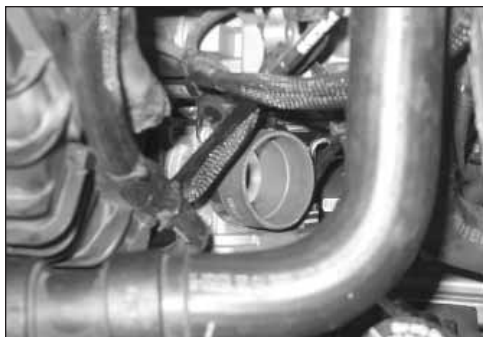

13. Install the silicone hose (08108) onto throttle body and secure with the provided hose clamp.



14. Install the supplied grommet into the intake tube as shown.



15. Remove the air temperature sensor from the factory intake tube as shown.
NOTE: Be careful removing the air temperature sensor as it is very fragile.

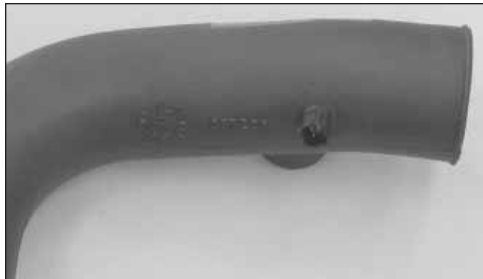

16. Install the air temperature sensor into the grommet. **NOTE: Be careful installing the air temperature sensor as it is very fragile.**



17. Install the supplied 1/4" npt vent fitting into the threaded boss in the K&N intake tube as shown.



18. Install saddle clamp onto the supplied bracket (26636) with the hardware provided.

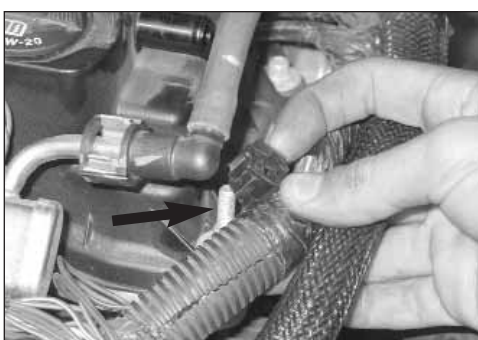

19. Unhook the wiring harness from the corner valve cover bolt as shown.

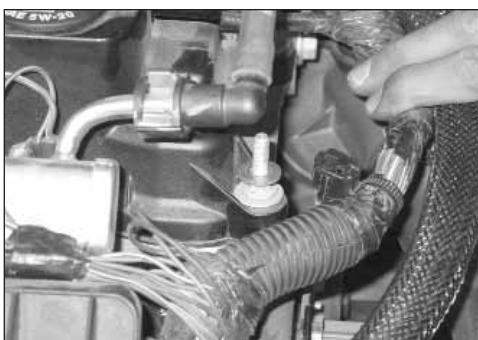

20. Place one washer onto the valve cover stud as shown.



21. Install the tube mounting bracket assembly onto the valve cover stud and secure with the provided hardware.
NOTE: Do not completely tighten at this time.



22. Install rubber mounted stud using the large fender washers provided.



23. Install the long edge trim along the top of the heat shield as shown.
NOTE: Some trimming of the edge trim may be necessary.



24. Install the short edge trim into the tube pass through hole as shown.
NOTE: Some trimming of the edge trim may be necessary.



25. Install heat shield onto the mounting studs and secure with the two nuts removed in step #12 and the provided hardware.



26. Install the K&N intake tube into the silicone hose and align onto the saddle clamp. Then secure with the provided hose clamps. Tighten bolts in #21.

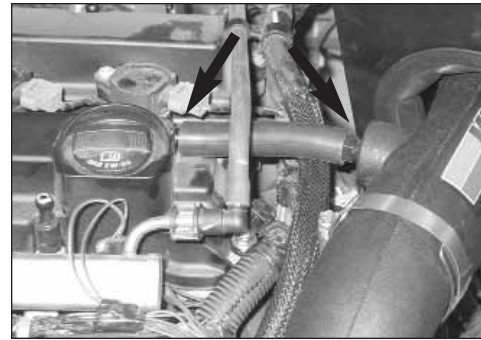

27. Install the provided crank case vent hose onto the valve cover. Then onto the fitting installed into the K&N intake tube.
NOTE: Some trimming of the vent hose may be necessary.



28. Reconnect the air temperature sensor electrical connection.

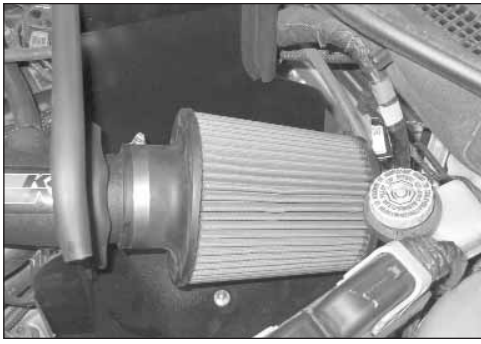

29. Install the K&N air filter and secure with the provided hose clamp.



30. Install the fresh air duct into the heat shield and onto the core support. Then secure with the factory quarter turn fasteners.



31. Reinstall the engine cover onto the engine.



32. Reconnect the vehicle's negative battery cable. Double check to make sure everything is tight and properly positioned before starting the vehicle.

33. It will be necessary for all K&N Performance Intake Kit's to be checked periodically for realignment, clearance and tightening of all connections. Failure to follow the above instructions or proper maintenance may void warranty.

ROAD TESTING:

1. Start the engine with the transmission in neutral or park, and the parking brake engaged. Listen for air leaks or odd noises. For air leaks secure hoses and connections. For odd noises, find cause and repair before proceeding. This kit will function identically to the factory system except for being louder and much more responsive.

2. Test drive the vehicle. Listen for odd noises or rattles and fix as necessary.

3. If road test is fine, you can now enjoy the added power and performance from your kit.

4. K&N suggests checking the Air filter element periodically for excessive dirt build-up. When the element becomes covered in dirt (or once a year), service it according to the instructions on the Recharger service kit, part number 99-5050 or 99-5000.

FREE K&N DECAL To register your warranty, please see us online at knfilters.com/register. FREE K&N DECAL