

INSTALLATION INSTRUCTIONS

57-3042

CADILLAC

2004-06 CTS
V6-3.6L DOHC
2005-06 CTS
V6-2.8L

TOOLS NEEDED:

- Flat Blade Screwdriver
- Phillips Screwdriver
- 10mm Wrench
- 15mm Wrench
- 4mm Allen
- Ratchet
- Extension
- 10mm Socket

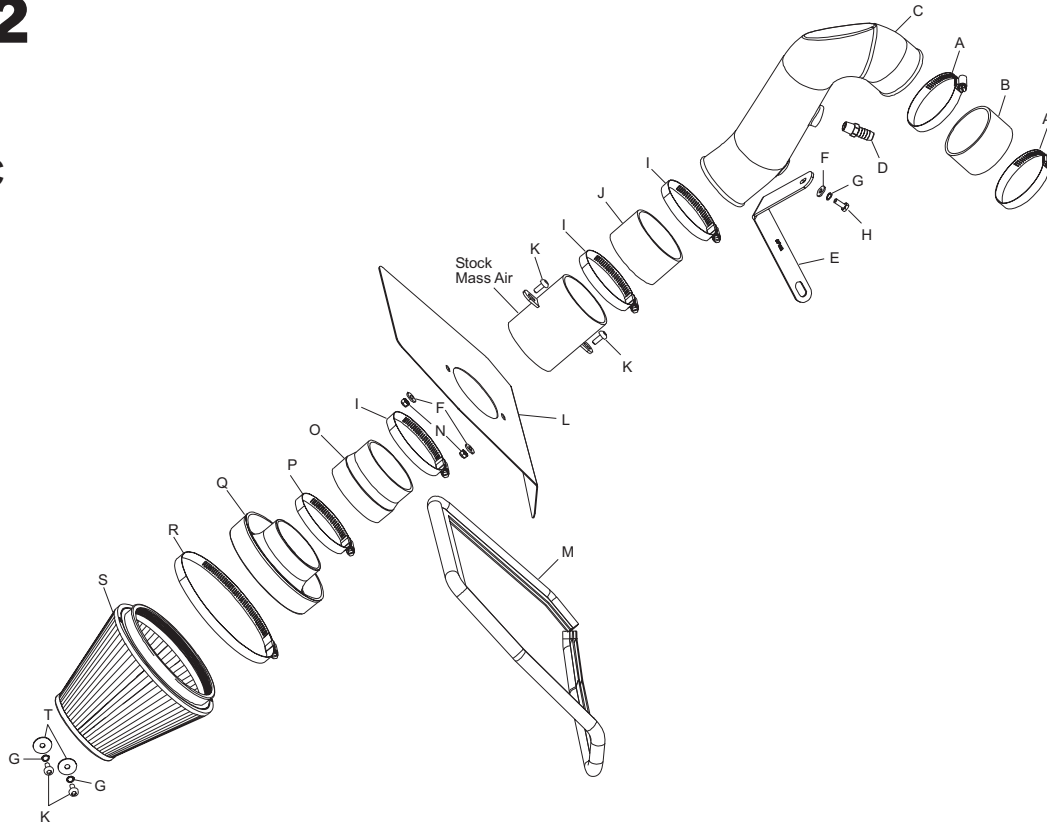

PARTS LIST:

| Desc. | QTY. | Part # |
|---------------------------|------|---------|
| A hose clamp #48 | 2 | 08601 |
| B silicone hose | 1 | 08190 |
| C intake tube (DO) | 1 | 087110 |
| D vent, 1/4"npt 1/2" barb | 1 | 080022 |
| E bracket, lg. L | 1 | 07188 |
| F flat washer; 1/4"id | 3 | 08275 |
| G lock washer; 1/4"id | 3 | 08198 |
| H bolt;hex 6mm-1.00x16mm | 1 | 07703 |
| I hose clamp #52 | 3 | 08610 |
| J silicone hose | 1 | 08690 |
| K bolt,B/H/A;m6-1.00x16mm | 4 | 07730 |
| L heat shield | 1 | 074019 |
| M edge trim 42" | 1 | 102499 |
| N nylock nut; 6mm | 2 | 07553 |
| O silicone step hose | 1 | 08051 |
| P hose clamp #56 | 1 | 08620 |
| Q filter adapter #380 | 1 | 21512 |
| R hose clamp # 104 | 1 | 08697 |
| T fender washer;1"idx1/4" | 2 | 08160 |
| S Filter Charger | 1 | RF-1048 |

NOTE: FAILURE TO FOLLOW INSTALLATION INSTRUCTIONS AND NOT USING THE PROVIDED HARDWARE MAY DAMAGE THE INTAKE TUBE, THROTTLE BODY, AND ENGINE.

TO START:

1. Turn the ignition OFF and disconnect the vehicle's negative battery cable.



2. Disconnect the mass air sensor electrical connection.



3. Remove oil cap, then pull up on engine cover to release from its retainers.



4. Disconnect the crank case vent hose from the intake plenum.



5. Loosen the two hose clamps on the intake plenum, then remove the intake plenum from the vehicle as shown.

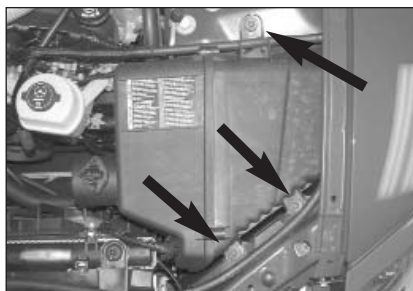

6. Remove the three bolts that secure the air box to the vehicle.



7. Remove the air box from the vehicle as shown.

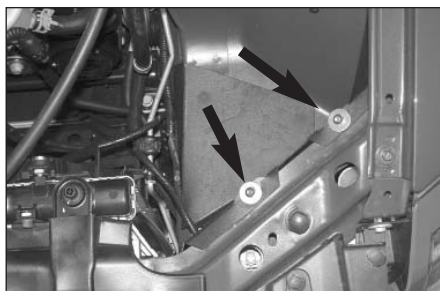

8. Secure the splash shield onto the vehicle with the provided hardware as shown.



9. Remove the two screws that secure the mass air sensor to the air box, then remove the mass air sensor.

NOTE: Remove the mass air sensor gasket from the mass air sensor.



10. Install silicone hose (#08190) onto the throttle body with the provided hose clamps as shown.



11. Remove the power steering pump mounting bolt shown with a 15mm wrench.



12. Install the K&N "L" bracket (#07188) as shown with the bolt removed in step #11.



13. Install the provided NPT fitting onto the K&N intake tube as shown.



14. Install the new K&N intake tube onto the throttle body and secure with the provided hose clamp. Secure the tube to the K&N tube bracket with the hardware provided.



15. Install the crankcase vent hose onto the K&N intake tube NPT fitting as shown.



16. Install the mass air sensor onto the heatshield with the provided hardware as shown.



17. Install the edge trim onto the heatshield as shown. Trim if needed.



18. Install the silicone hose (#08690) onto the mass air assembly with the provided hose clamps as shown.



19. Install the heat shield assembly onto the K&N intake tube and secure with the provided hose clamp.



20. Install the silicone hose (#08051) onto the filter adapter and secure with the provided hose clamps as shown.

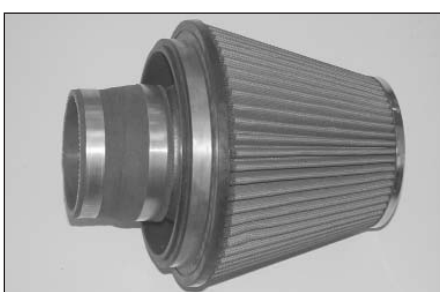

21. Install the K&N Filtercharger onto the filter adapter as shown.



22. Install the filtercharger assembly onto the mass air sensor and secure with the provided hose clamp.



23. Reconnect the mass air sensor electrical connection as shown.



24. Reinstall the engine cover and oil cap removed in step #3.

25. Reconnect the vehicle's negative battery cable. Double check to make sure everything is tight and properly positioned before starting the vehicle.

26. The C.A.R.B. exemption sticker, (attached), must be visible under the hood so that an emissions inspector can see it when the vehicle is required to be tested for emissions. California requires testing every two years, other states may vary.

27. It will be necessary for all FIPK's to be checked periodically for realignment, clearance and tightening of all connections. Failure to follow the above instructions or proper maintenance may void warranty.

ROAD TESTING:

1. Start the engine with the transmission in neutral or park, and the parking brake engaged. Listen for air leaks or odd noises. For air leaks secure hoses and connections. For odd noises, find cause and repair before proceeding. This kit will function identically to the factory system except for being louder and much more responsive.

2. Test drive the vehicle. Listen for odd noises or rattles and fix as necessary.

3. If road test is fine, you can now enjoy the added power and performance from your kit.

4. K&N suggests checking the Filtercharger element periodically for excessive dirt build-up. When the element becomes covered in dirt (or once a year), service it according to the instructions on the Recharger service kit, part number 99-5050 or 99-5000.