

INSTALLATION INSTRUCTIONS

57-3040 CADILLAC 2003-04 CTS V6-3.2 DOHC

NOTE: This kit was not designed to fit vehicles with a body lift.

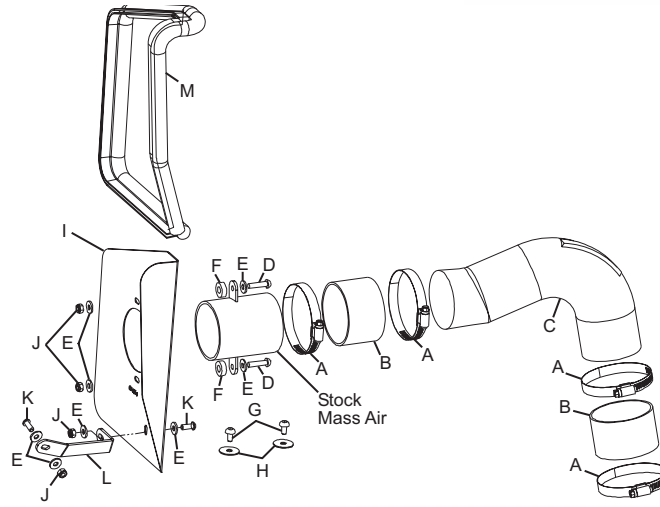
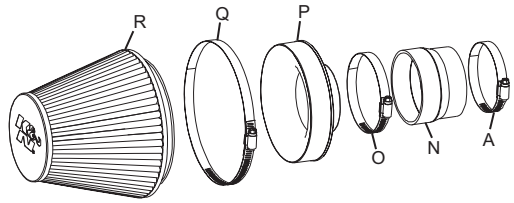

PARTS LIST:

Desc.	Qty.	Part #
A hose clamp #48	5	08601
B silicone hose	2	08434
C intake tube (DG)	1	087102
D B/H/A; m6-1.00 x 25mm	2	07729
E 1/4" id x 5/8" od flat washer	8	08275
F 1/4" id x 5/8" x 1/4" L spacer	2	06555
G B/H/A; m6-1.00 x 12mm	2	07794
H 1/4" id x 1.0" od fender washer	2	08160
I heat shield	1	074014
J 6mm-1.00 nylock nut	4	07553
K B/H/A; m6-1.00 x 16mm	2	07730
L bracket	1	07184
M edge trim 39"L	1	102496
N silicone step hose	1	08051
O hose clamp #52	1	08610
P filter adapter #380	1	21512
Q hose clamp #104	1	08697
R filtercharger	1	RF-1048

TOOLS NEEDED:

Flat Blade Screwdriver
Phillips Screwdriver
10mm Wrench
4mm Allen Wrench
Ratchet
Extension
10mm Socket

NOTE: FAILURE TO FOLLOW INSTALLATION INSTRUCTIONS AND NOT USING THE PROVIDED HARDWARE MAY DAMAGE THE INTAKE TUBE, THROTTLE BODY AND ENGINE.

TO START:

1. Turn the ignition OFF and disconnect the vehicle's negative battery cable.

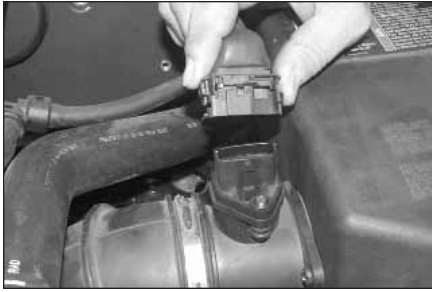

2. Disconnect the mass air sensor electrical connection.

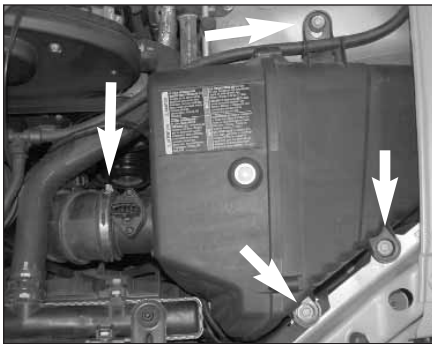

3. Loosen hose clamp at the mass air, then remove the three 10mm bolts that secure air box to vehicle.



4. Remove air box from vehicle as shown.



5. Loosen the lower hose clamp on the intake tube, then remove intake tube as shown.

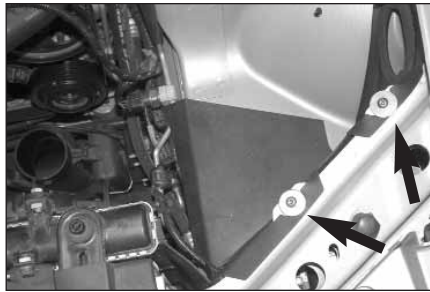

6. Secure splash shield onto vehicle with the provided hardware as shown.



7. Remove the two screws that secure the mass air sensor to air box, then remove mass air sensor.

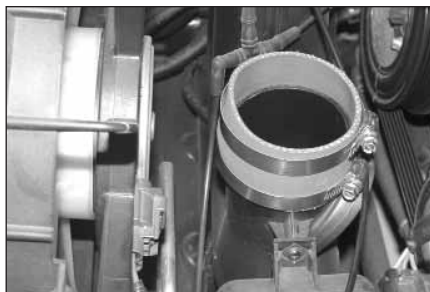

8. Install silicone hose (08434) onto intake track with the provided hose clamps as shown.



9. Install the new K&N intake tube onto the intake track and secure with the provided hose clamps.

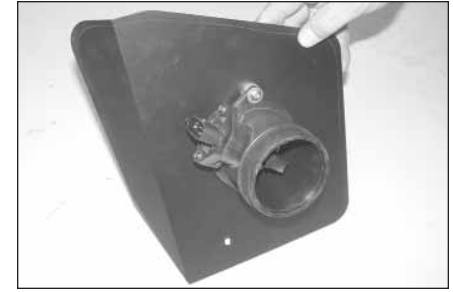

10. Install the mass air sensor onto the heat shield with the provided spacers and hardware as shown.

NOTE: Install spacers between heat shield and mass air.



11. Install edge trim onto heat shield as shown. Trim if needed.



12. Attach the bracket onto heat shield with the provided hardware as shown.



13. Install silicone hose (08434) onto the mass air assembly with the provided hose clamps as shown.



14. Install the heat shield assembly onto the vehicle, then attach intake tube to silicone hose and secure bracket to wheel well as shown.



15. Install the silicone hose (08051) onto the filter adapter as shown.



16. Install the filter adapter onto the mass air sensor with the provided hose clamps.

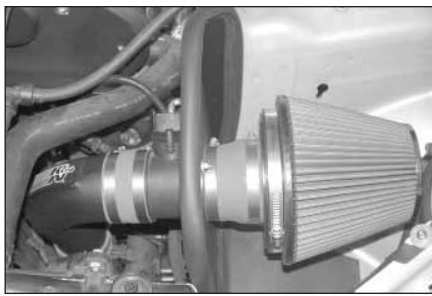

17. Install the K&N filtercharger onto the mass air assembly as shown.

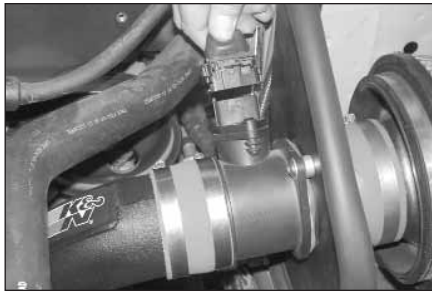

18. Reconnect the mass electrical connection as shown.



19. Reconnect the vehicle's negative battery cable. Double check to make sure everything is tight and properly positioned before starting the vehicle.

20. The C.A.R.B. exemption sticker, (attached), must be visible under the hood so that an emissions inspector can see it when the vehicle is required to be tested for emissions. California requires testing every two years, other states may vary.

21. It will be necessary for all FIPK's to be checked periodically for realignment, clearance and tightening of all connections. Failure to follow the above instructions or proper maintenance may void warranty.

ROAD TESTING:

1. Start the engine with the transmission in neutral or park, and the parking brake engaged. Listen for air leaks or odd noises. For air leaks secure hoses and connections. For odd noises, find cause and repair before proceeding. This kit will function identically to the factory system except for being louder and much more responsive.
2. Test drive the vehicle. Listen for odd noises or rattles and fix as necessary.
3. If road test is fine, you can now enjoy the added power and performance from your kit.
4. K&N suggests checking the Filtercharger element periodically for excessive dirt build-up. When the element becomes covered in dirt (or once a year), service it according to the instructions on the Recharger service kit, part number 99-5050 or 99-5000.