

**INSTALLATION INSTRUCTIONS**

**57-3011  
CHEVROLET**

**1994-96 IMPALA SS, CAPRICE  
V8-5.7L**

NOTE: This kit was not designed to fit vehicles with a body lift.

**TOOLS NEEDED:**

- Large Flat Blade Screwdriver
- Large Phillips Head Screwdriver
- 5mm Allen Wrench
- 10mm Wrench
- 5/32" Allen Wrench
- 3/8" Wrench
- Clean Rag

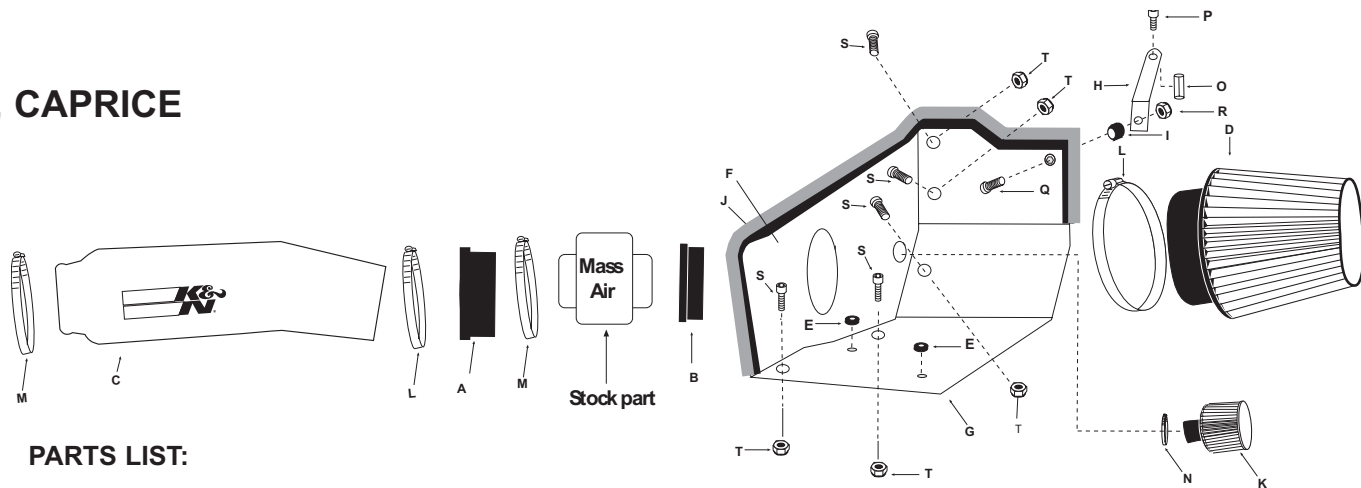

**PARTS LIST:**

Desc.	Qty.	Part #	Desc.	Qty.	Part #	Desc.	Qty.	Part #
A. Tube Adapter	1	21546-1	H. Bracket	1	07929	O. Coupling Nut	1	08252
B. Filter Adapter	1	21547-1	I. Spacer	1	079195	P. 1/4-28x1/2" Bolt	1	08367
C. Intake Tube	1	08875	J. Trim Seal	1	102489	Q. 6mm Bolt	1	07859
D. Air Filter	1	RF-1021	K. A.I.R. Filter	1	62-1030	R. 6mm Nylock Nut	1	07553
E. Grommet	2	08061	L. Hose Clamp #72	2	08671	S. 10-32x3/8" Bolt	5	08387
F. Heat Shield- A	1	07094	M. Hose Clamp #60	2	08624	T. 10-32 Nylock Nut	5	08253
G. Heat Shield- B	1	07095	N. Hose Clamp #12 Mini	1	08420			

**NOTE: FAILURE TO FOLLOW INSTALLATION INSTRUCTIONS AND NOT USING THE PROVIDED HARDWARE MAY DAMAGE THE INTAKE TUBE, THROTTLE BODY, AND ENGINE.**

**TO START:**

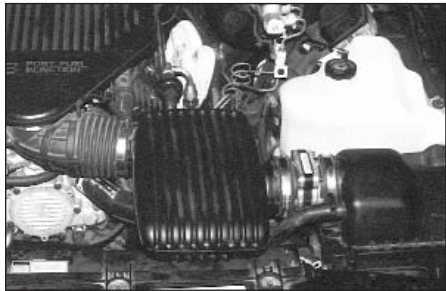

1. Turn the ignition OFF and disconnect the vehicle's negative battery cable.



2. Disconnect the mass air sensor electrical connection.

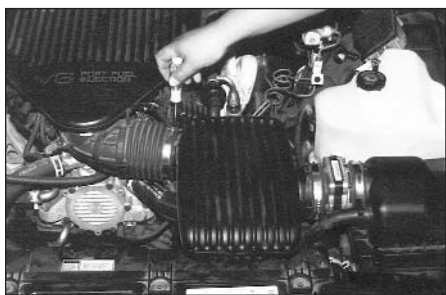

3. Use phillips head screwdriver to loosen hose clamp.

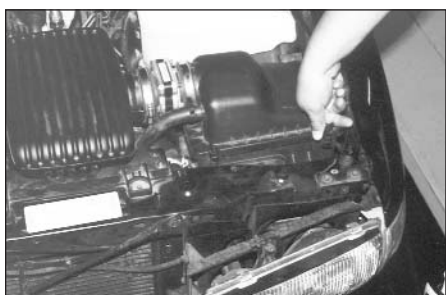

4. Remove airbox wingnuts.

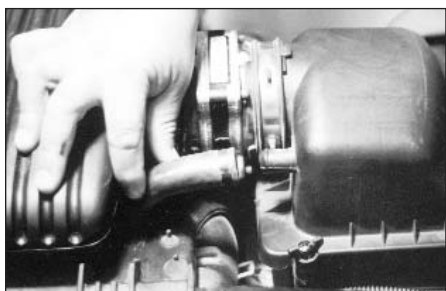

5. Detach the air injection hose from the airbox.

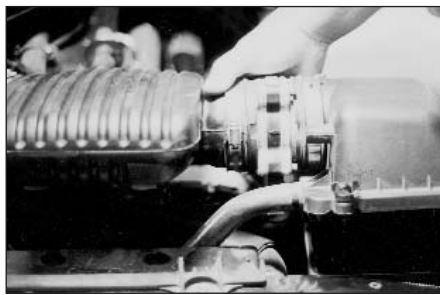

6. Lift up and remove upper airbox and sound chamber housing. Remove air filter and discard.

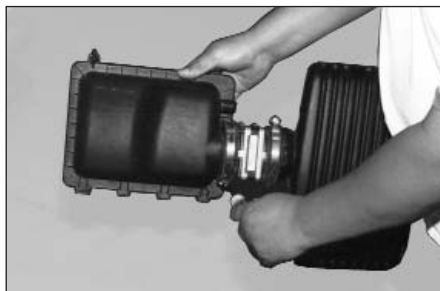

7. Remove the mass air sensor from upper airbox sound chamber housing.



8. Remove the screw that secures the airbox housing to the fender. Push in the lower tabs that secure the computer cover, then remove the complete assembly.

**NOTE: K&N recommends that customers do not discard factory air intake.**



9. Remove the computer cover from the lower airbox housing.  
**NOTE: Push clips must be retained in computer cover.**

10. Re-install the computer cover without the top piece attached.



11. Assemble the heat shield by using nylock nuts and allen head bolts provided.



12. Install trim seal on edge of heat shield.  
**NOTE: Some trimming may be necessary for the best fit.**



13. Insert the grommets provided, into the holes onto the bottom side of the heat shield.



14. Install the filter adapter onto the mass air sensor. The notch in the adapter aligns with the tab on the mass air sensor.  
**NOTE: The adapter should be placed on the side marked this side towards the air cleaner.**

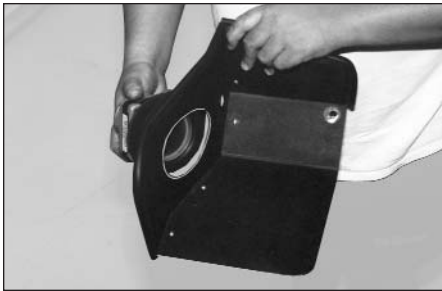

15. Install the mass air sensor into the hole in the heat shield.

**NOTE: This is a very snug fit.**

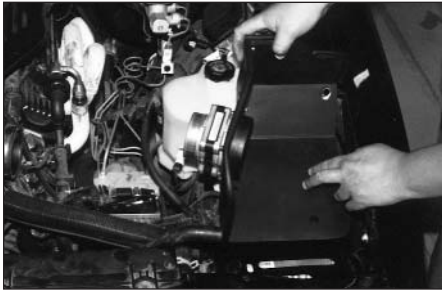

16. Install the heat shield by lining up the push clips with the two holes the grommets were inserted into. The heat shield will snap into place when properly seated.



17. Thread the provided coupling nut onto the stud that protrudes through the windshield washer reservoir. Tighten down securely.



18. Attach the bracket to the heat shield with the provided hardware. As shown in the parts list above. Tighten down securely.



19. Attach the bracket to the coupling nut with the provided bolt. Tighten down securely.



20. Install the hose clamps on the tube adapter and install this assembly onto the intake tube.



21. Install intake tube assembly by pushing end into rubber bellows assembly on engine.



22. Install loose end of intake tube on mass air sensor and tighten all hose clamps.



23. Oil the air filter with the provided oil. Insert the air filter through the hole in the heat shield. connect the air injection hose to the air filter and secure with hose clamp.

**NOTE: The air injection hose will have to be routed under the radiator hose to reach.**

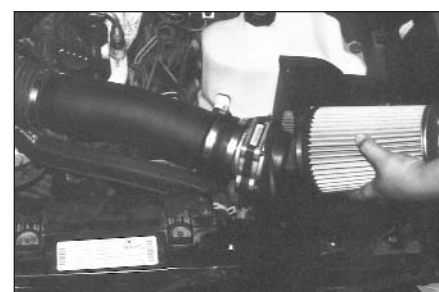

24. Install the air filter element with hose clamp and tighten.



25. Reconnect the vehicle's mass air sensor and negative battery cable. Double check to make sure everything is tight and properly positioned before starting the vehicle.

26. The C.A.R.B. exemption sticker, (attached), must be visible under the hood so that an emissions inspector can see it when the vehicle is required to be tested for emissions. California requires testing every two years, other states may vary.

27. It will be necessary for all FIPK's to be checked periodically for realignment, clearance and tightening of all connections. Failure to follow the above instructions or proper maintenance may void warranty.

#### ROAD TESTING:

1. Start the engine with the transmission in neutral or park, and the parking brake engaged. Listen for air leaks or odd noises. For air leaks secure hoses and connections. For odd noises, find cause and repair before proceeding. This kit will function identically to the factory system except for being louder and much more responsive.

2. Test drive the vehicle. Listen for odd noises or rattles and fix as necessary.

3. If road test is fine, you can now enjoy the added power and performance from your kit.

4. K&N suggests checking the air filter element periodically for excessive dirt build-up. When the element becomes covered in dirt (or once a year), service it according to the instructions on the Recharger service kit, part number 99-5050 or 99-5000.