



FUEL INJECTION PERFORMANCE KIT

FIPK

GENERATION II™

INSTALLATION INSTRUCTIONS

57-2547

Ford

2002-04 Focus SVT
L4-2.0L

NOTE: This kit was not designed to fit vehicles with a body lift.

TOOLS NEEDED:

Flat Blade Screwdriver
5mm Allen Wrench
8mm Wrench
7/16 Wrench
Ratchet
10mm Wrench
7/16 Socket
T25 Torx

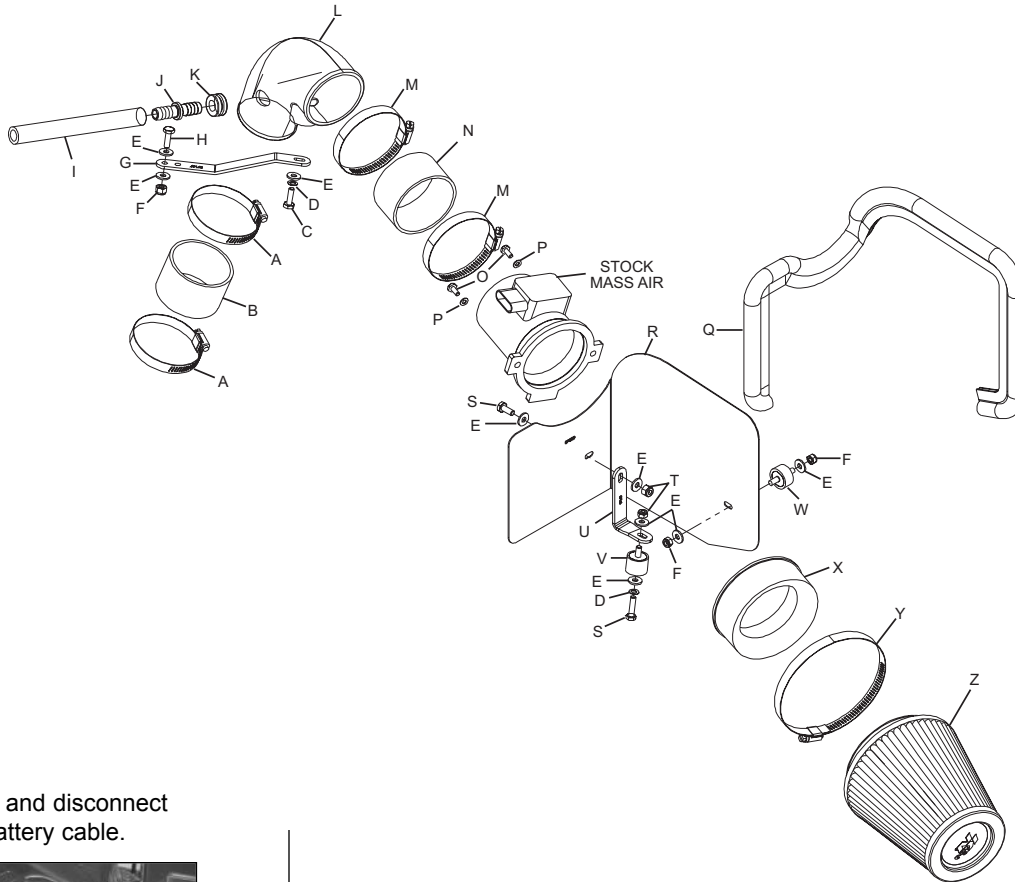

PARTS LIST:

Desc.	QTY.	Part #
A hose clamp #44	2	08577
B silicone hose	1	08756
C 6mm x 10mm bolt	1	07863
D 6mm wave washer	2	08174
E 1/4" flat washer	9	08275
F 6mm nylock nut	3	07553
G Bracket	1	07167
H 6mm x 25mm bolt	1	07704
I silicone hose 1/2 x 7"	1	08159
J hose mender /12"	1	08686
K grommet 1" od 1/2" id	1	08064
L intake tube (cv)	1	087089
M hose clamp #48	2	08601
N silicone hose	1	08190
O 5mm x 12mm bolt	2	07855
P 5mm flat washer	2	08212
Q edge trim 33"L	1	102498
R heat shield	1	074003
S 1/4" - 20 x 5/8 bolt	2	08315
T 1/4" - 20 nylock nut	2	07517
U Bracket, med "L"	1	07166
V rubber bumper 3/4 thick m/f	1	070226
W 6mm rubber bumper m/m	1	07027
X mass air adapter #270	1	21560
Y hose clamp #72	1	08671
Z filter	1	RP-5101

TO START:

1. Turn the ignition OFF and disconnect the vehicle's negative battery cable.



2. Disconnect the mass air sensor electrical connection.



3. Pull up firmly to remove the throttle linkage cover as shown.



4. Pull up firmly to remove the coil pack cover as shown.

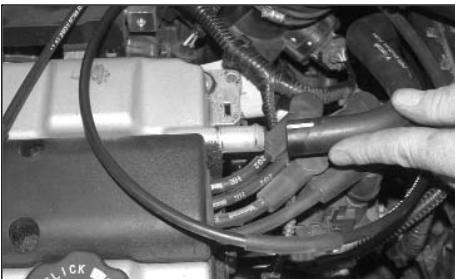

5. Disconnect the crank case vent hose from valve cover as shown.



6. Release the clamp at the throttle body as shown.



7. Pull up firmly to remove the complete air box assembly from vehicle as shown.

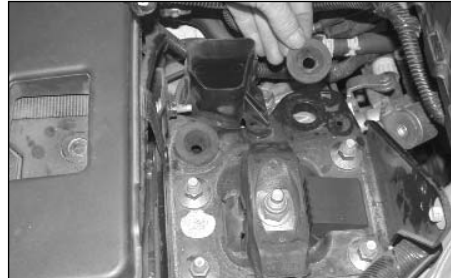

8. Remove the rubber grommet from the air box mounting bracket as shown.

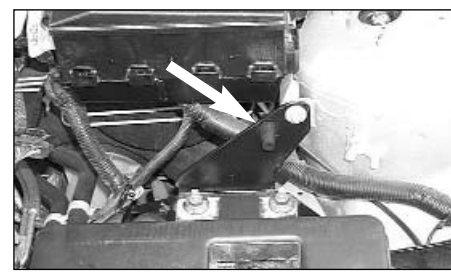

9. Remove rubber bumper from the air box mounting location.

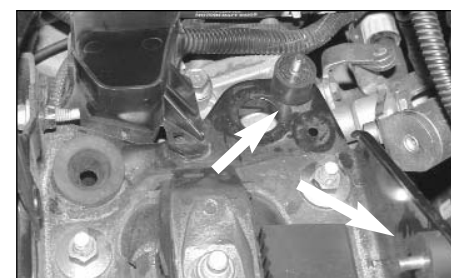

10. Install the provided bumper studs onto the air box mounting bracket as shown.
NOTE: The 3/4 long bumper stud mounts to the bottom of tray.



11. Install the new bracket onto the intake tube with the provided hardware as shown.



12. Install the provided grommet onto the intake tube as shown.



13. Install the silicone hose (08756) onto the throttle body with the provided hose clamps.



14. Install the new intake tube onto the throttle body, then mount the bracket onto the valve cover with the provided hardware.

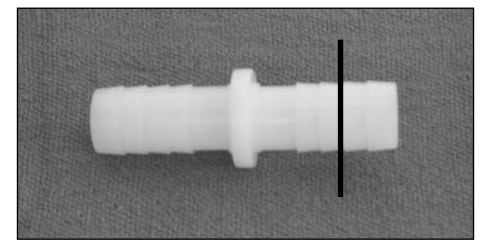

15. On the provided hose mender cut off 2 of the barbs as shown.



16. Install the hose mender onto the intake tube.
NOTE: Install the end that was cut in the previous step.

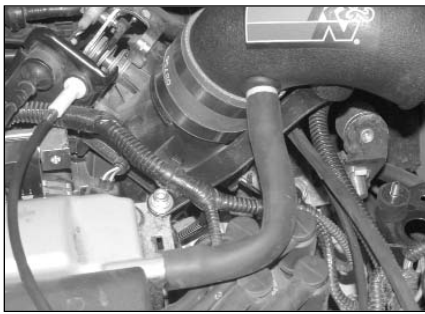

17. Reconnect the crank case vent with the provided silicone hose as shown.



18. Install the bracket onto the heatshield as shown.

NOTE: Do not tighten completely.



19. Install the edge trim onto the heatshield as shown. Trim if needed.



20. Install the heatshield assembly onto the vehicle and then secure to the bumper studs as shown.



21. Remove clamp that secures the intake tube to the mass air sensor then remove hose.



22. Unscrew the mass air sensor from the air box then remove the mass air sensor.



23. Bolt the mass air sensor onto the filter adaptor with the provided hardware as shown.

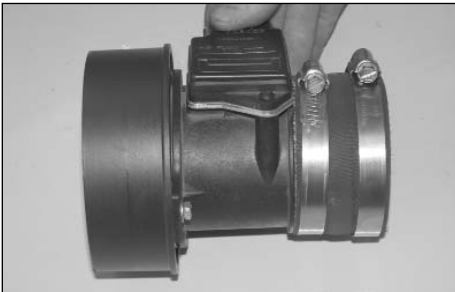

24. Install the silicone hose (08190) onto the mass air sensor with the provided hose clamp.



25. Install the mass air sensor assembly onto the intake tube as shown.



26. Reconnect the mass air sensor electrical connection as shown.



27. Install the K&N Filtercharger onto the mass air sensor as shown.



28. Reinstall the coil pack cover and the throttle cable cover that were removed in step 3 & 4.



29. Reconnect the vehicle's negative battery cable. Double check to make sure everything is tight and properly positioned before starting the vehicle.

30. The C.A.R.B. exemption sticker, (attached), must be visible under the hood so that an emissions inspector can see it when the vehicle is required to be tested for emissions. California requires testing every two years, other states may vary.

31. It will be necessary for all FIPK's to be checked periodically for realignment, clearance and tightening of all connections. Failure to follow the above instructions or proper maintenance may void warranty.

ROAD TESTING:

1. Start the engine with the transmission in neutral or park, and the parking brake engaged. Listen for air leaks or odd noises. For air leaks secure hoses and connections. For odd noises, find cause and repair before proceeding. This kit will function identically to the factory system except for being louder and much more responsive.

2. Test drive the vehicle. Listen for odd noises or rattles and fix as necessary.

3. If road test is fine, you can now enjoy the added power and performance from your kit.

4. K&N suggests checking the Filtercharger element periodically for excessive dirt build-up. When the element becomes covered in dirt (or once a year), service it according to the instructions on the Recharger service kit, part number 99-5000 or 99-5050.