



## INSTALLATION INSTRUCTIONS

### 57-1538

### DODGE 2004-09 DURANGO V8-4.7L

**NOTE:** This kit was not designed to fit vehicles with a body lift.

#### TOOLS NEEDED:

4MM Allen Wrench  
10MM Socket  
13MM Socket  
15MM Socket  
17MM Socket  
9/16" Socket  
10MM Wrench  
13MM Wrench  
Extension  
Flat Blade Screwdriver  
Ratchet

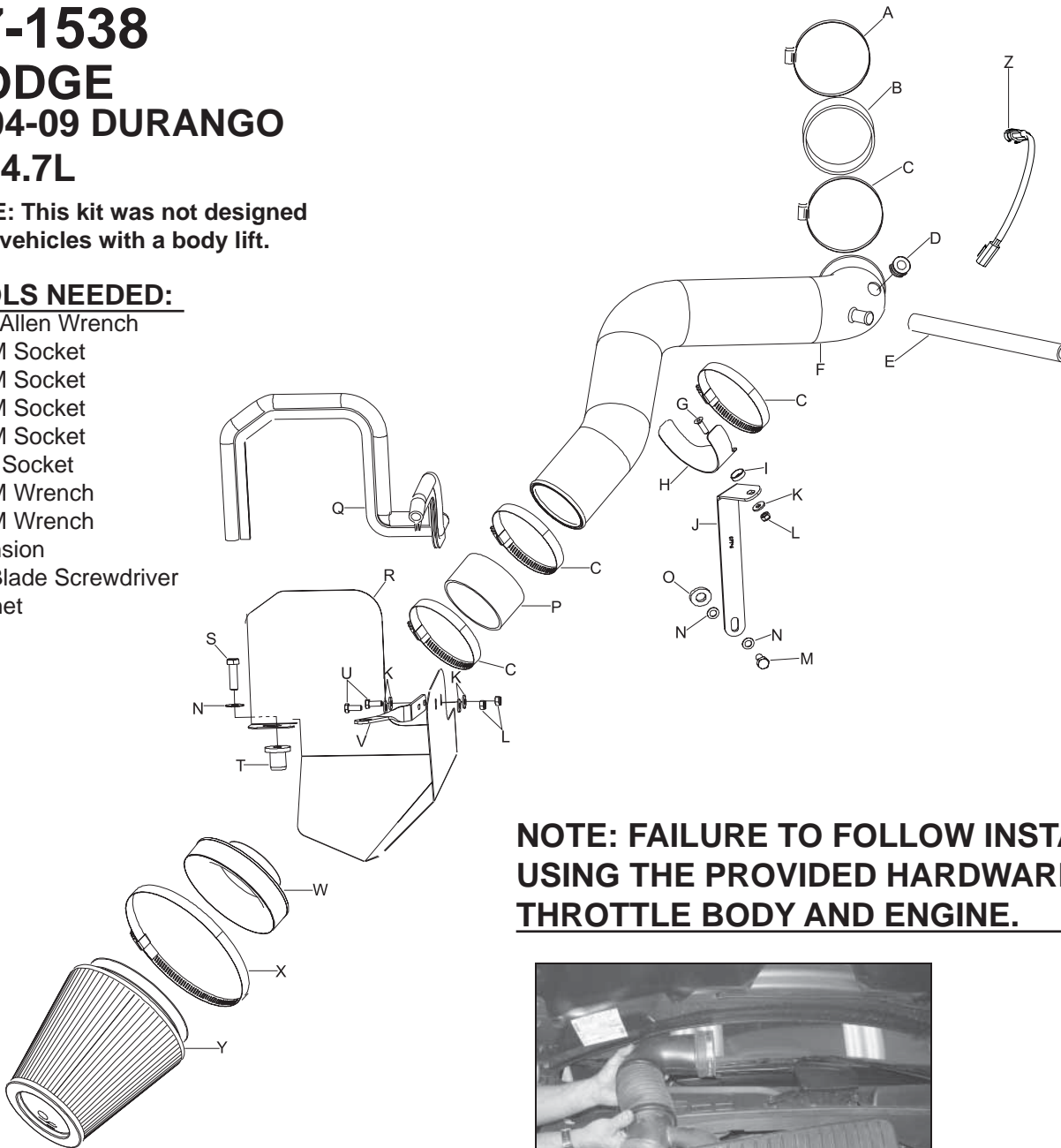

#### PARTS LIST:

Description	Qty.	Part #
A	1	08610
B	1	08051
C	4	08620
D	1	08064
E	1	08177
F	1	087117
G	1	08376
H	1	078855
I	1	08180
J	1	07155
K	5	08275
L	3	07553
M	1	07702
N	3	08134
O	1	08281
P	1	08630
Q	1	102471
R	1	074023
S	1	07779
T	1	08163
U	2	07703
V	1	07197
W	1	21512
X	1	08697
Y	1	RC-5138
Z	1	21680

**NOTE: FAILURE TO FOLLOW INSTALLATION INSTRUCTIONS AND NOT USING THE PROVIDED HARDWARE MAY DAMAGE THE INTAKE TUBE, THROTTLE BODY AND ENGINE.**

#### TO START:

1. Turn off the ignition and disconnect the negative battery cable.

**NOTE: Disconnecting the negative battery cable erases pre-programmed electronic memories. Write down all memory settings before disconnecting the negative battery cable. Some radios will require an anti-theft code to be entered after the battery is reconnected. The anti-theft code is typically supplied with your owner's manual. In the event your vehicles' anti-theft code cannot be recovered, contact an authorized dealership to obtain your vehicles anti-theft code.**

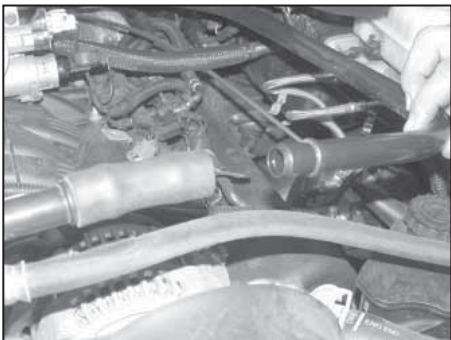

2. On 2005 and earlier vehicles, disconnect the crankcase vent tube from the vent hose junction above the alternator.



2a. On 2006 and later vehicles, disconnect the crankcase vent tube from the airbox lid as shown.



3. Loosen the intake tube hose clamps and remove the intake tube assembly from the vehicle.

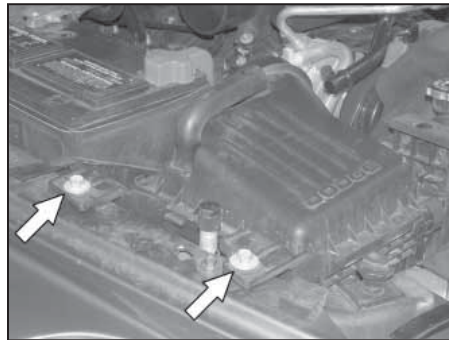

4. Remove the two airbox retaining bolts.



5. Pull up firmly to dislodge the airbox from mounting grommet, and remove the airbox from the vehicle.

**NOTE: K&N Engineering, Inc., recommends that customers do not discard factory air intake.**

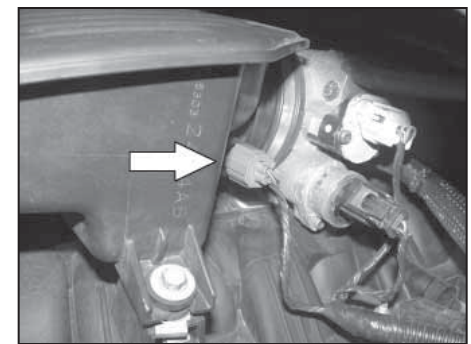

6. Depress the locking tab on the air temp sensor electrical connection and disconnect the air temp electrical connector.



7. Remove the two 10mm resonator retaining bolts, then remove the resonator from the vehicle.



7a. On 2006 and later vehicles, disconnect the crankcase vent tube from the rear of the intake manifold.

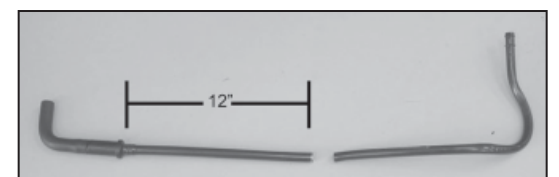

7b. On 2006 and later vehicles, measure 12" from the crankcase check valve and cut the crankcase vent tube as shown.



7c. Install the provided silicone hose onto the cut crankcase vent hose as shown and then reconnect the hose assembly onto the intake manifold.

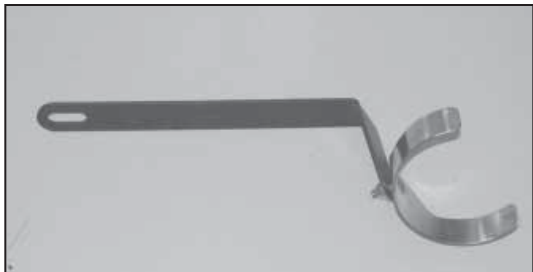

8. Assemble the saddle clamp to the tube bracket with the provided hardware as shown.

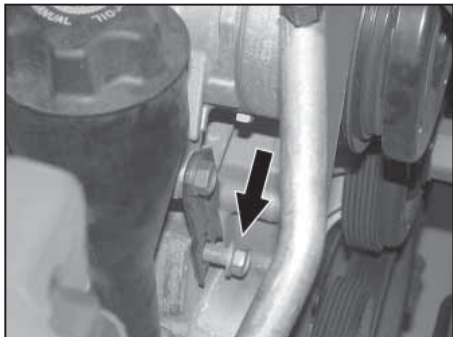

9. Remove the lower a/c bracket bolt shown with a 15mm socket.

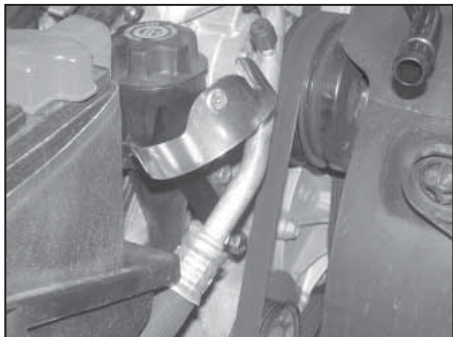

10. Install the tube bracket assembly onto the engine using the provided hardware, threading the bolt into the vacated hole by the bolt removed in step #9.

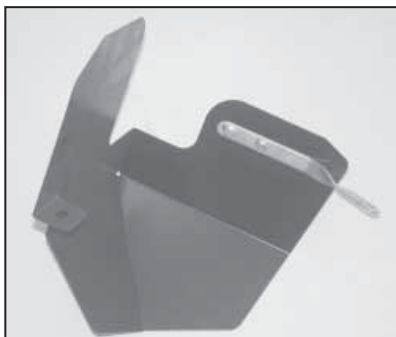

11. Install the heat shield bracket (07197) onto the heat shield with the provided hardware.

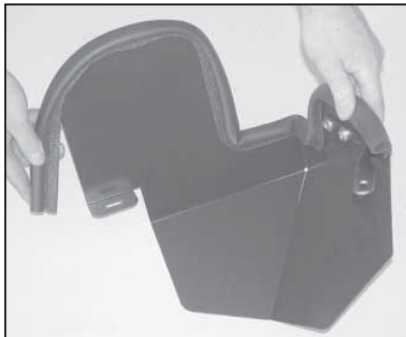

12. Install the provided edge trim onto the heat shield.  
**NOTE: Some trimming of the edge trim will be necessary.**

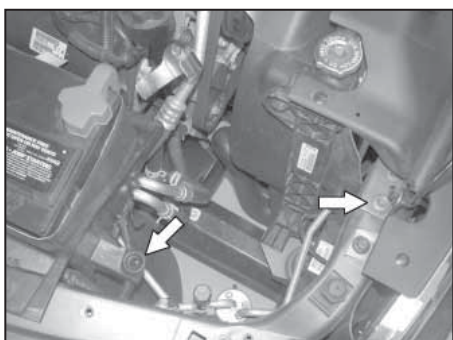

13. Remove the core support mounting bolt shown with a 13mm wrench, and pull out the stock airbox mounting grommet shown.

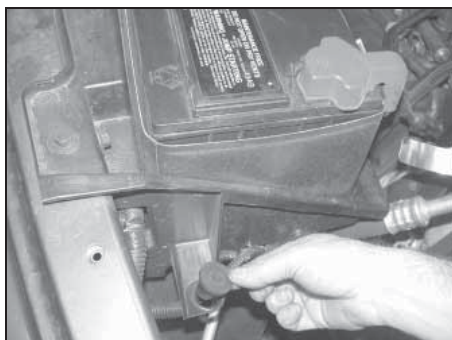

14. Install the 3/8" threaded insert provided into the airbox mounting grommet hole vacated in step #13.

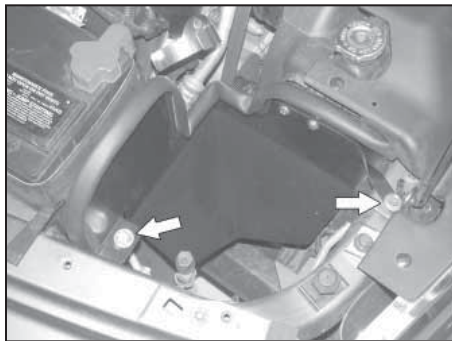

15. Install the K&N® heat shield assembly and secure the mounting bracket to the radiator core support with original bolt removed in step #13. Secure the rear of the heat shield to the 3/8" threaded insert with the provided hardware.

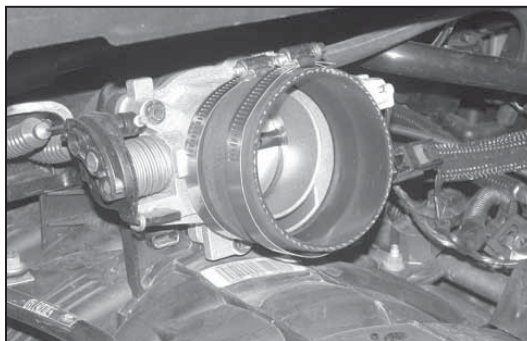

16. Install the silicone hose (08051) onto the throttle body and secure with the provided hardware.

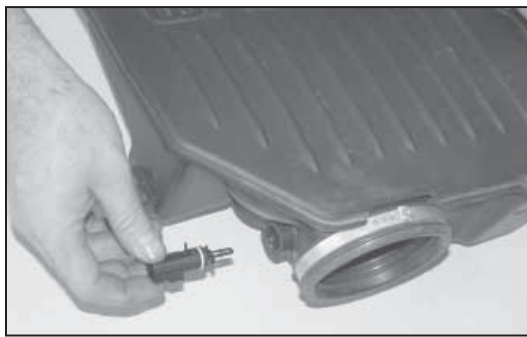

17. Twist the temp sensor counter clockwise to unlock and remove the temp sensor from the factory resonator.



18. Install the provided grommet into the K&N® intake tube as shown.



19. Remove the O-ring from the air temp sensor as shown.



20. Install the air temp sensor into the K&N® intake tube as shown.

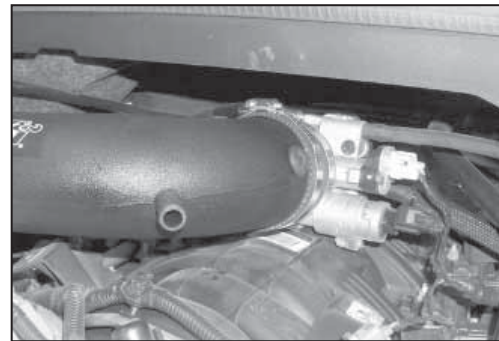

21. Install the intake tube onto the throttle body with the provided hose clamp.



22. Using the provided hose clamp, secure the K&N® intake tube to the saddle bracket assembly as shown.

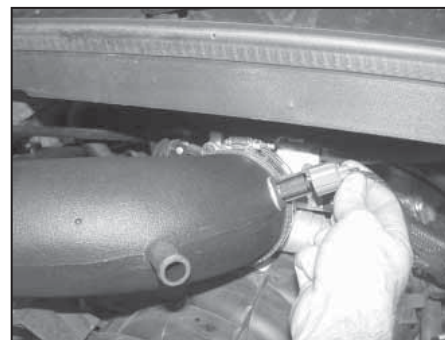

23. Reconnect the temp sensor electrical connection.  
**NOTE: It may be necessary to use the provided temperature sensor wiring harness extension on some models due to factory wiring harness changes.**

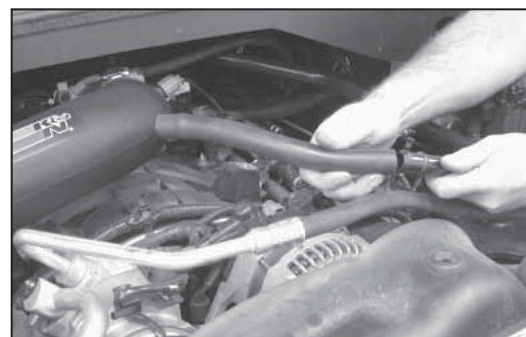

24. On 2005 and earlier vehicles connect the provided silicone hose to the K&N® intake tube, then connect to the factory crankcase vent tube.



24a. On 2006 and later vehicles connect the crankcase vent hose installed in step #7c to the K&N® intake tube as shown.



25. On 2005 and earlier vehicles remove the crankcase vent tube mounting clip from the crankcase vent tube on the airbox as shown.



26. On 2006 and earlier vehicles install the crankcase vent tube mounting clip onto the a/c line and crankcase vent tube as shown.

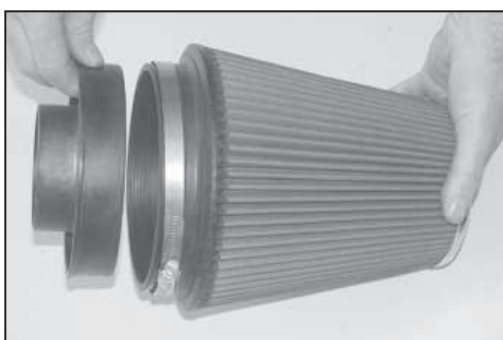

27. Install the provided radiused filter adapter into the K&N® air filter and secure with the provided hose clamp.

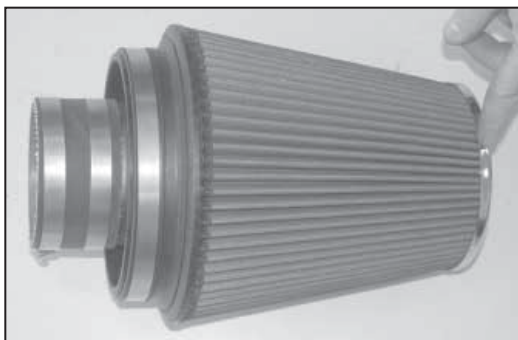

28. Install the silicone hose (08630) onto the K&N® air filter assembly and then secure with the provided hose clamp.



29. Install the K&N® air filter assembly onto the K&N® intake tube and secure with the provided hose clamp.



30. Reconnect the vehicle's negative battery cable. Double check to make sure everything is tight and properly positioned before starting the vehicle.

31. The C.A.R.B. exemption sticker, (attached), must be visible under the hood so that an emissions inspector can see it when the vehicle is required to be tested for emissions. California requires testing every two years, other states may vary.

32. It will be necessary for all K&N® high flow intake systems to be checked periodically for realignment, clearance and tightening of all connections. Failure to follow the above instructions or proper maintenance may void warranty.

#### ROAD TESTING:

1. Start the engine with the transmission in neutral or park. Listen for air leaks or odd noises. For air leaks secure hoses and connections. For odd noises, find cause and repair before proceeding. This kit will function identically to the factory system except for being louder and much more responsive.

2. Test drive the vehicle. Listen for odd noises or rattles and fix as necessary.

3. If road test is fine, you can now enjoy the added power and performance from your kit.

4. K&N Engineering, Inc., suggests checking the air filter element periodically for excessive dirt build-up. When the element becomes covered in dirt (or once a year), service it according to the instructions on the Recharger® service kit, part number 99-5050 or 99-5000.

# 50-STATE STREET LEGAL



# CARB EXEMPT



\* FREE K&N® decal To register your warranty, please see us online at [knfilters.com/register](http://knfilters.com/register). FREE K&N® decal \*