

**PLEASE READ THE INSTRUCTIONS CAREFULLY BEFORE FITTING THE KIT**

Follow the sequence 1 to 9.3, together with the drawings.

**If you have a problem, however small, call our Technical Department.**

Tel:- 01925 636950. Fax:- 01925 243111. Mon - Thurs 8.30 - 5pm.

- 1 Remove the plastic air duct from the front panel and from the air intake pipe. **Drawing A.**
- 2 Release the front grille **Drawing A.**
- 3 Press spring clip to remove the plug from the sensor. **Drawing B.** Unscrew the sensor and remove . Release **Hose A.**
- 4 Remove the breather hose, **Drawing B** and release the small **Hose B.**
- 5 Using the side cutters, or stanley knife (take care), remove the plastic tie attached to the intake to the airbox, pull out the cable, **Drawing C,** Remove the intake pipe from the air filter box and from the flexi air intake pipe.
- 6 Release the large hose clip, **Drawing B,** and lift out the complete air box assembly .
- 7 First screw the sensor into the shortened inlet on the tapered adapter, **see Drawing D** for fitting instructions. **Read carefully, before fitting this filter. Push hose A and hose B,** just inside the holes in the base of the air filter. **Drawing F,** fit the filter to the metal tube. Tighten the clip, until it just rotates, then one full turn (360 degree's). **No more. Do not overtighten.**
- 8 **SAFETY NOTE, DRAWING E. FOLLOW THE INSTRUCTIONS CAREFULLY.**
- 9 **Fitting the essential cold air system Drawing D & G.**
- 9.1 **See Drawings H1. H2 & H3** for attaching cold air hose to duct.
- 9.2 Feed the rubber hose down behind the grille, position hose to achieve the best intake flow **Drawing G.** Refit the plastic air duct to the front panel. **Drawing D.**
- 9.3 Fit the tapered end of straight cold air hose into the flexi pipe. Secure with two long plastic ties, as **Drawing D.**
10. **Tuning.**  
**CAT. Cars.** No adjustments are required.  
An increase in fuel may be required if further engine modifications are carried out.
- 11 **Filter maintenance.**  
Under normal conditions clean and reoil the filter at approx. 40,000 miles / 65,000 Km.  
**Use only K&N cleaner** and oil with this kit and reoil and follow the instructions carefully.

**K&N Filters are pre oiled ready to fit.**

**The advantage's of K&N's cold air system.**

Cooler air being denser, will show positive improvements in power filter systems that draw hot air from the engine bay.

**This Kit Should Contain :-**

- 1 x Air filter.
- 1 x Nylon Adaptor
- 1 x Rubber breather hose.
- 2 x Rubber cold air hoses
- 1 x Instruction sheet
- 1 x Instruction pack.
  - 1 x Filter maintenance sheet
  - 1 x K&N Window Sticker
  - 1 x Million mile warranty card
  - 1 x Leaflet
- 1 x Fixing Kit
  - 1 x Hose Clip (Size 44)
  - 1 x Hose Clip (size 40.)
  - 1 x Hose Clip (size 40 thin.)
  - 2 x Plastic Cable Tie (35cm Long).
  - 2 x Plastic Cable Tie (10cm Long)
  - 1 x Metal Tube

**FITTING YOUR OWN 57i KIT**

If no **it is essential** that the person fitting the kit (e.g mechanic) **carefully follows these particular instructions** even if he has fitted K&N kits before. This will save you both time and money. Kits incorrectly fitted may show a loss in performance e.g the positioning of the essential cold air hose, (flexi expandable and rubber hoses are used).

**A final check** under the bonnet by yourself with the instructions, would seem sensible.

Release the four screws.  
Pull the grille section forward to give access for fitting the new rubber hose

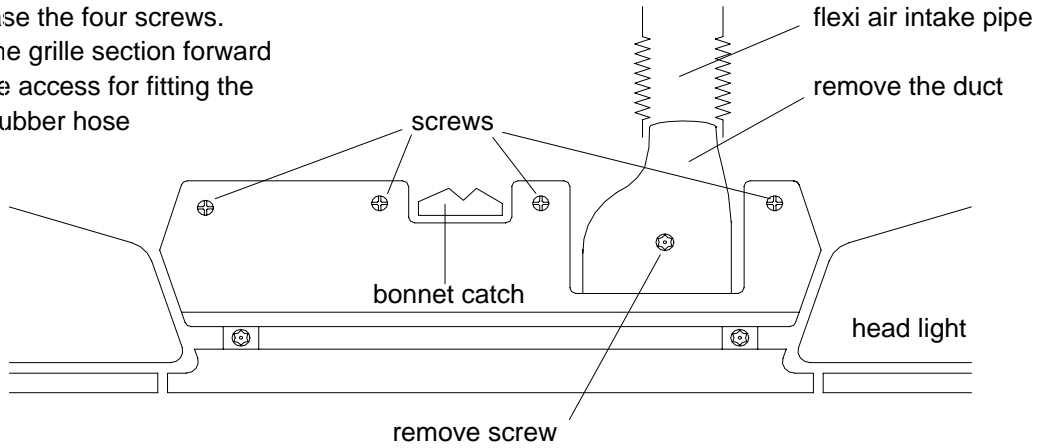

Drawing B

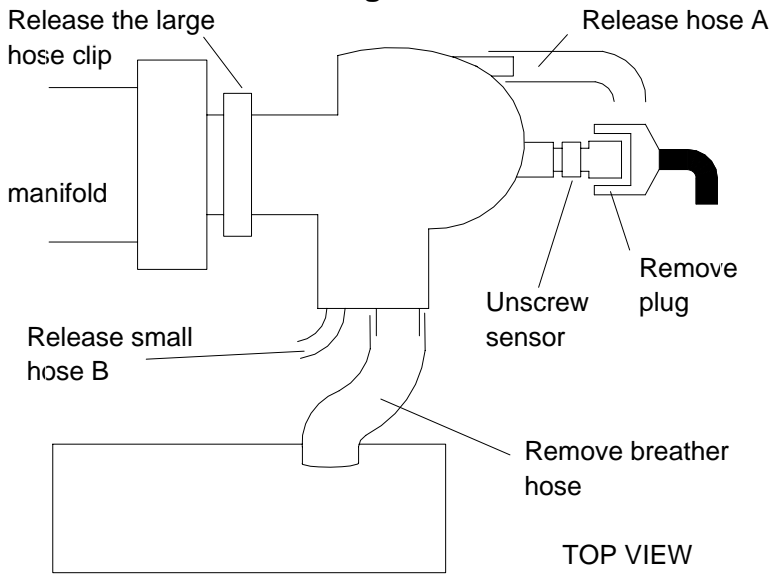

Drawing C

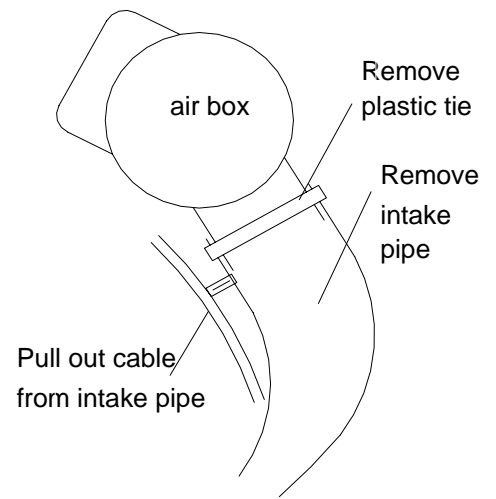

Drawing D

1- Screw sensor into short outlet first

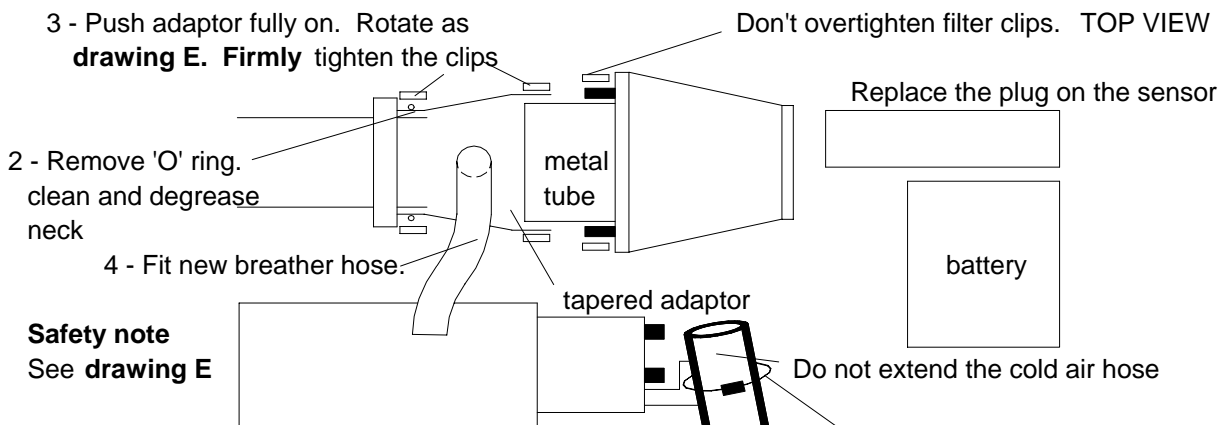

Drawing D-1

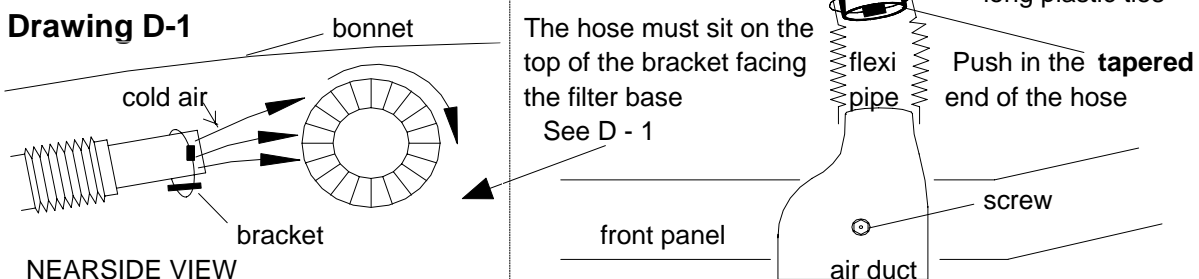

**Drawing E**

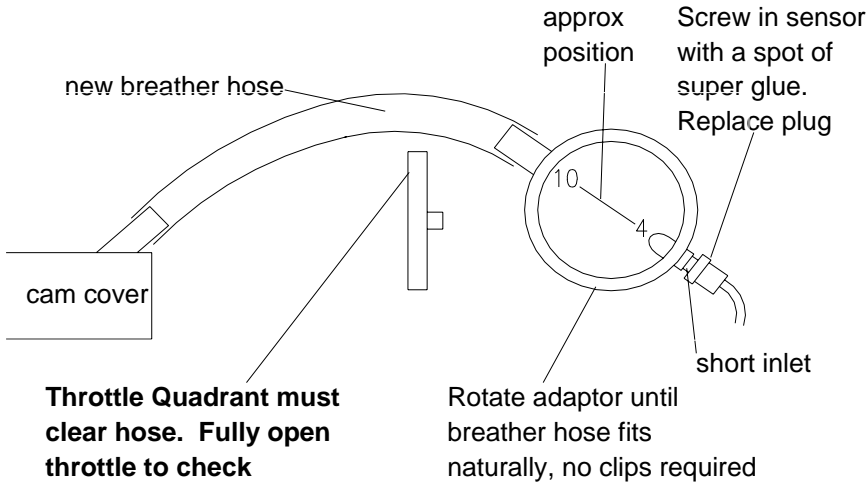

**Drawing F**

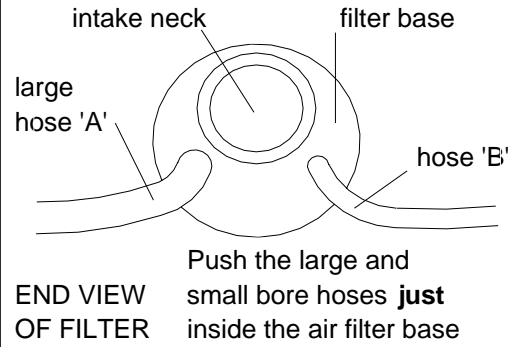

**Drawing G**

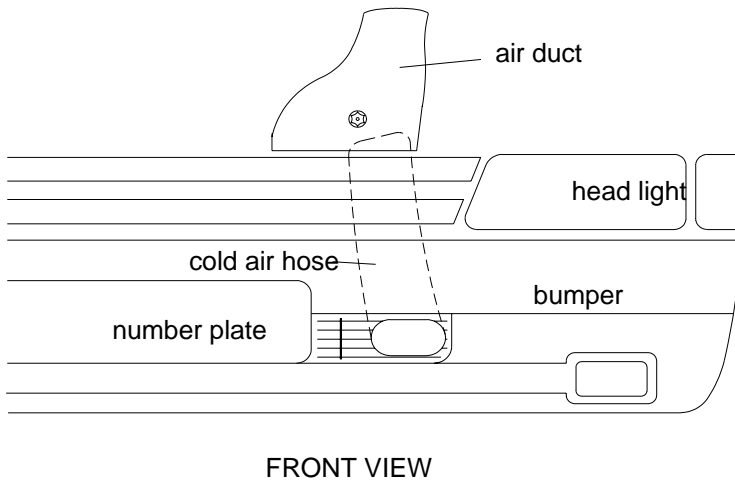

**Drawing H1**

TOP VIEW

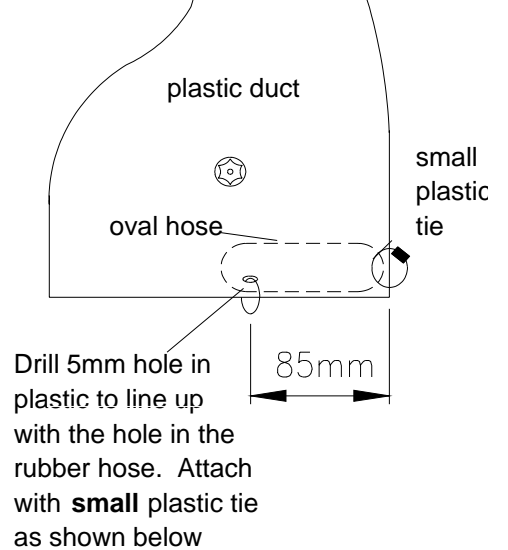

**Drawing H2**

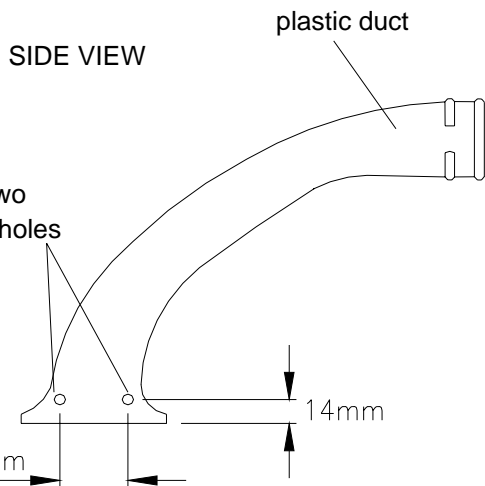

**Drawing H3**

